



**STAINLESS STEEL PIPE SPOOL
PARTS CATALOG**

STAINLESS STEEL PIPE SPOOLS

SECTION 1 - PART NUMBERING & DESCRIPTION

PIPE SPOOL PIECE

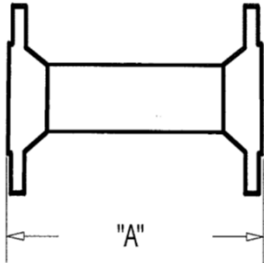

304-X-PS-A
316-X-PS-A

304 = TYPE 304/304L STAINLESS STEEL
316 = TYPE 316/316L STAINLESS STEEL
X = PIPE SIZE
PS = PIPE SPOOL
A = FACE TO FACE LENGTH

45 DEGREE ELBOW

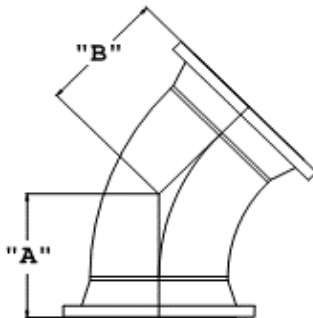

304-X-E45-A-B
316-X-E45-A-B

304 = TYPE 304/304L STAINLESS STEEL
316 = TYPE 316/316L STAINLESS STEEL
X = PIPE SIZE
E45 = FITTING TYPE
A = LENGTH OF PIPE ADDED TO LEG "A"
B = LENGTH OF PIPE ADDED TO LEG "B"

90 DEGREE ELBOW, SHORT RADIUS

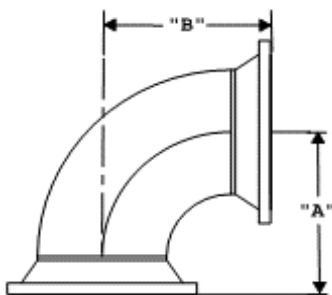

304-X-E90S-A-B
316-X-E90S-A-B

304 = TYPE 304/304L STAINLESS STEEL
316 = TYPE 316/316L STAINLESS STEEL
X = PIPE SIZE
E90S = FITTING TYPE
A = LENGTH OF PIPE ADDED TO LEG "A"
B = LENGTH OF PIPE ADDED TO LEG "B"

90 DEGREE ELBOW, LONG RADIUS

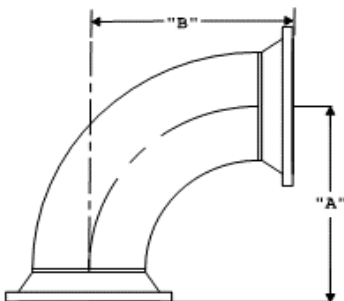

304-X-E90L-A-B
316-X-E90L-A-B

304 = TYPE 304/304L STAINLESS STEEL
316 = TYPE 316/316L STAINLESS STEEL
X = PIPE SIZE
E90L = FITTING TYPE
A = LENGTH OF PIPE ADDED TO LEG "A"
B = LENGTH OF PIPE ADDED TO LEG "B"

STAINLESS STEEL PIPE SPOOLS

SECTION 1 - PART NUMBERING & DESCRIPTION

CONCENTRIC REDUCER

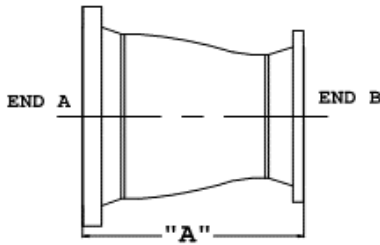

CONCENTRIC

304-X-Y-CON-RED-A-B

316-X-Y-CON-RED-A-B

304 = TYPE 304/304L STAINLESS STEEL

316 = TYPE 316/316L STAINLESS STEEL

X = LARGE PIPE SIZE

Y = SMALL PIPE SIZE

CON-RED = FITTING TYPE

A = LENGTH OF PIPE ADDED TO LARGE END

B = LENGTH OF PIPE ADDED TO SMALL END

ECCENTRIC REDUCER

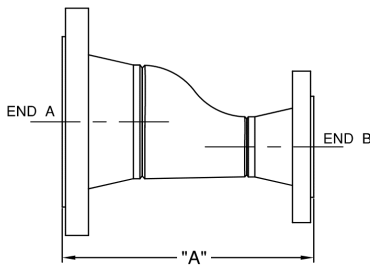

ECCENTRIC

304-X-Y-ECC-RED-A-B

316-X-Y-ECC-RED-A-B

304 = TYPE 304/304L STAINLESS STEEL

316 = TYPE 316/316L STAINLESS STEEL

X = LARGE PIPE SIZE

Y = SMALL PIPE SIZE

ECC-RED = FITTING TYPE

A = LENGTH OF PIPE ADDED TO LARGE END

B = LENGTH OF PIPE ADDED TO SMALL END

TEE

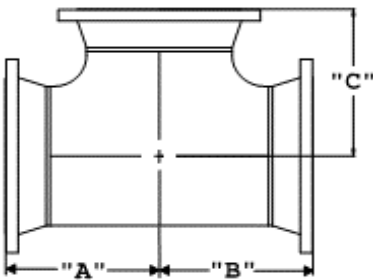

304-X-TEE-A-B-C

316-X-TEE-A-B-C

304 = TYPE 304/304L STAINLESS STEEL

316 = TYPE 316/316L STAINLESS STEEL

X = PIPE SIZE

TEE = FITTING TYPE

A = LENGTH OF PIPE ADDED TO "A" DIMENSION

B = LENGTH OF PIPE ADDED TO "B" DIMENSION

C = LENGTH OF PIPE ADDED TO "C" DIMENSION

REDUCING TEE

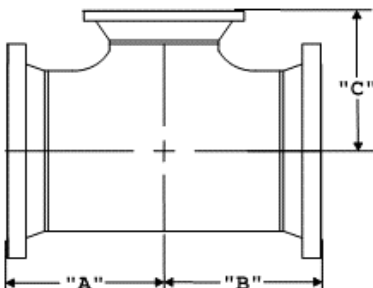

304-X-Y-RT-A-B-C

316-X-Y-RT-A-B-C

304 = TYPE 304/304L STAINLESS STEEL

316 = TYPE 316/316L STAINLESS STEEL

X = RUN PIPE SIZE

y = BRANCH PIPE SIZE

RT = FITTING TYPE

A = LENGTH OF PIPE ADDED TO "A" DIMENSION

B = LENGTH OF PIPE ADDED TO "B" DIMENSION

C = LENGTH OF PIPE ADDED TO "C" DIMENSION

CROSS

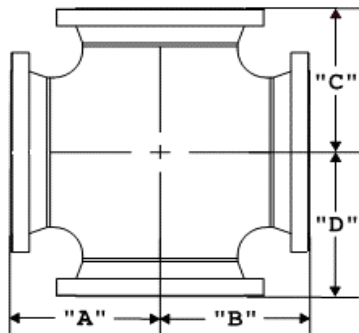

304-X-CRS-A-B-C-D
316-X-CRS-A-B-C-D

304 = TYPE 304/304L STAINLESS STEEL
316 = TYPE 316/316L STAINLESS STEEL
X = PIPE SIZE
CRS = FITTING TYPE
A = LENGTH OF PIPE ADDED TO "A" DIMENSION
B = LENGTH OF PIPE ADDED TO "B" DIMENSION
C = LENGTH OF PIPE ADDED TO "C" DIMENSION
D = LENGTH OF PIPE ADDED TO "D" DIMENSION

STAINLESS STEEL PIPE SPOOLS
SECTION 1 - PART NUMBERING & DESCRIPTION

REDUCING CROSS (QUOTE PER ORDER)

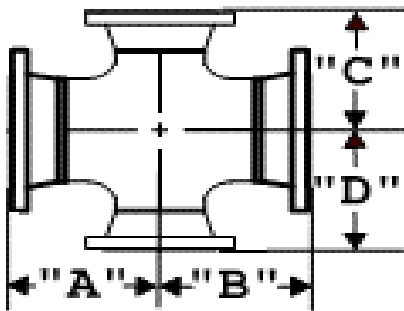

304-X-RC-A-B-C-D
316-X-RC-A-B-C-D

304 = TYPE 304/304L STAINLESS STEEL
316 = TYPE 316/316L STAINLESS STEEL
X = MAIN PIPE SIZE
Y = BRANCH PIPE SIZE
RC = FITTING TYPE
A = LENGTH OF PIPE ADDED TO "A" DIMENSION
B = LENGTH OF PIPE ADDED TO "B" DIMENSION
C = LENGTH OF PIPE ADDED TO "C" DIMENSION
D = LENGTH OF PIPE ADDED TO "D" DIMENSION

THREAD-O-LET*

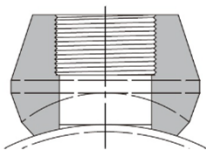

304-X-TOL-(LEG)-(DIS)-(ROT)
316-X-TOL-(LEG)-(DIS)-(ROT)

*THREAD-O-LET IS A SUB-PART TO A PIPE SPOOL
304 = TYPE 304/304L STAINLESS STEEL
316 = TYPE 316/316L STAINLESS STEEL
X = SIZE OF OUTLET
LEG = LEG OF FITTING O-LET WILL BE INSTALLED ON ("A", "B", "C" OR "D")
DIS = DISTANCE IN INCHES FROM FACE OF FLANGE TO CENTERLINE OF O-LET
ROT = DEG OF ROTATION THAT O-LET IS TO BE INSTALLED. (SEE FULL NOTES)

WELD-O-LET*

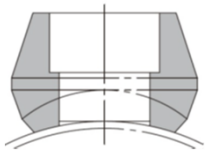

304-X-WOL-(LEG)-(DIS)-(ROT)
316-X-WOL-(LEG)-(DIS)-(ROT)

*WELD-O-LET IS A SUB-PART TO A PIPE SPOOL
304 = TYPE 304/304L STAINLESS STEEL
316 = TYPE 316/316L STAINLESS STEEL
X = SIZE OF OUTLET
LEG = LEG OF FITTING O-LET WILL BE INSTALLED ON ("A", "B", "C" OR "D")
DIS = DISTANCE IN INCHES FROM FACE OF FLANGE TO CENTERLINE OF O-LET
ROT = DEG OF ROTATION THAT O-LET IS TO BE INSTALLED. (SEE FULL NOTES)

CATCH BASIN

CB-304-WIDTH-LENGTH-HEIGHT

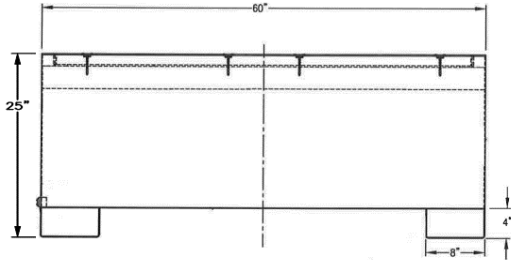

PIPE SPOOL WITH VERTICAL OFFSET

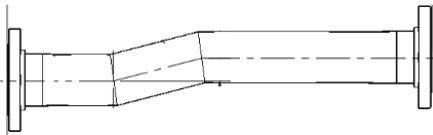

304-X-PS-Y-A-B-C-D

304 = TYPE 304/304L STAINLESS STEEL

316 = TYPE 316/316L STAINLESS STEEL

X = PIPE SIZE

PS = PIPE SPOOL

A = FACE TO FACE LENGTH

B = OFFSET

C = OFFSET STARTING AT

D = FLANGE TYPE

**STAINLESS STEEL PIPE SPOOLS
SECTION 2 - CATALOG PRICING**

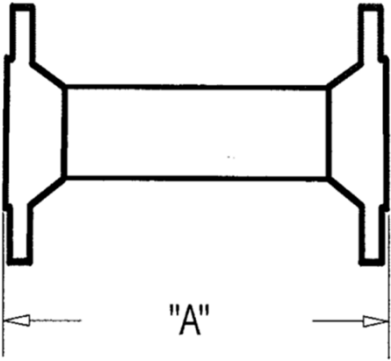
PIPE SPOOL	PART NUMBER	SIZE
	304-0.5-PS-A	1/2"
	304-1-PS-A	1"
	304-1.5-PS-A	1-1/2"
	304-2-PS-A	2"
	304-3-PS-A	3"
	304-4-PS-A	4"
	304-6-PS-A	6"
	304-8-PS-A	8"
	304-10-PS-A	10"
	304-12-PS-A	12"
	304-14-PS-A	14"
	304-16-PS-A	16"
	304-18-PS-A	18"
	304-20-PS-A	20"
	304-24-PS-A	24"

45 DEGREE ELBOW

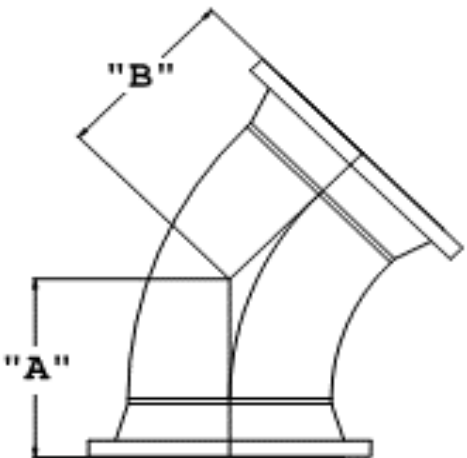
	304-2-E45-A-B	2"
	304-3-E45-A-B	3"
	304-4-E45-A-B	4"
	304-6-E45-A-B	6"
	304-8-E45-A-B	8"
	304-10-E45-A-B	10"
	304-12-E45-A-B	12"
	304-14-E45-A-B	14"
	304-16-E45-A-B	16"
	304-18-E45-A-B	18"
304-20-E45-A-B	20"	
304-24-E45-A-B	24"	

STAINLESS STEEL PIPE SPOOLS
SECTION 2 - CATALOG PRICING

90 DEGREE SHORT RADIUS ELBOW

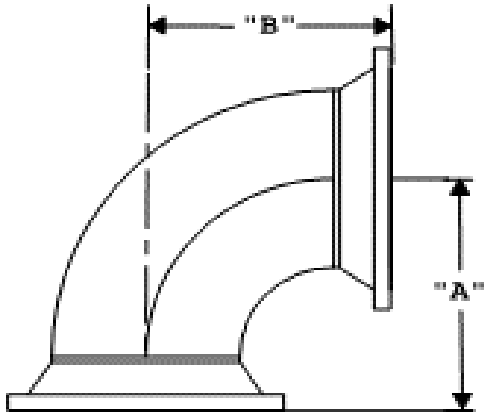

304-2-E90S-A-B	2"
304-3-E90S-A-B	3"
304-4-E90S-A-B	4"
304-6-E90S-A-B	6"
304-8-E90S-A-B	8"
304-10-E90S-A-B	10"
304-12-E90S-A-B	12"
304-14-E90S-A-B	14"
304-16-E90S-A-B	16"
304-18-E90S-A-B	18"
304-20-E90S-A-B	20"
304-24-E90S-A-B	24"

90 DEGREE LONG RADIUS ELBOW

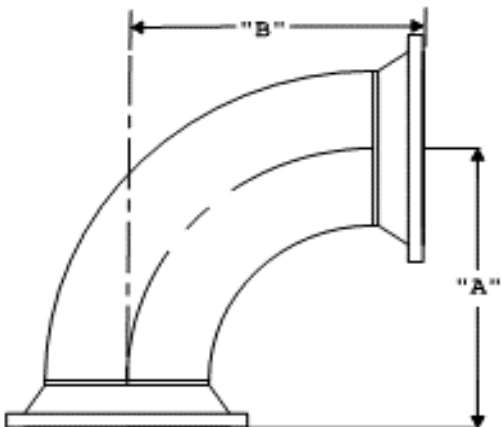

304-2-E90L-A-B	2"
304-3-E90L-A-B	3"
304-4-E90L-A-B	4"
304-6-E90S-A-B	6"
304-8-E90L-A-B	8"
304-10-E90L-A-B	10"
304-12-E90L-A-B	12"
304-14-E90L-A-B	14"
304-16-E90L-A-B	16"
304-18-E90L-A-B	18"
304-20-E90L-A-B	20"
304-24-E90L-A-B	24"

STAINLESS STEEL PIPE SPOOLS SECTION 2 - CATALOG PRICING

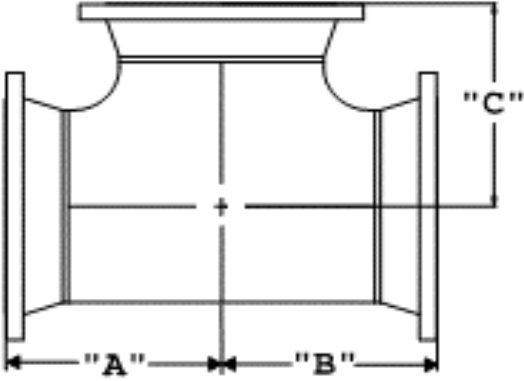
TEE	PART NUMBER	SIZE
	304-1.5-TEE-A-B-C	1-1/2"
	304-2-TEE-A-B-C	2"
	304-3-TEE-A-B-C	3"
	304-4-TEE-A-B-C	4"
	304-6-TEE-A-B-C	6"
	304-8-TEE-A-B-C	8"
	304-10-TEE-A-B-C	10"
	304-12-TEE-A-B-C	12"
	304-14-TEE-A-B-C	14"
	304-16-TEE-A-B-C	16"
	304-18-TEE-A-B-C	18"
304-20-TEE-A-B-C	20"	
304-24-TEE-A-B-C	24"	

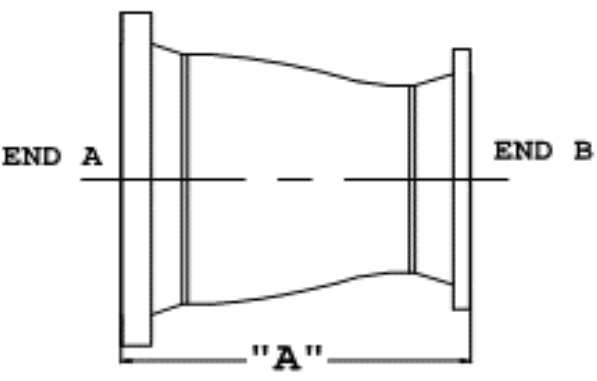
CONCENTRIC REDUCER	PART NUMBER	SIZE
	304-1-0.5-CON-RED-A-B	1" x 1/2"
	304-2-1-CON-RED-A-B	2" X 1"
	304-3-2-CON-RED-A-B	3" X 2"
	304-4-2-CON-RED-A-B	4" X 2"
	304-4-3-CON-RED-A-B	4" X 3"
	304-6-3-CON-RED-A-B	6" X 3"
	304-6-4-CON-RED-A-B	6" X 4"
	304-8-3-CON-RED-A-B	8" x 3"
	304-8-4-CON-RED-A-B	8" X 4"
	304-8-6-CON-RED-A-B	8" X 6"
	304-10-6-CON-RED-A-B	10" X 6"
	304-10-8-CON-RED-A-B	10" X 8"
	304-12-8-CON-RED-A-B	12" X 8"
	304-12-10-CON-RED-A-B	12" X 10"
	304-14-10-CON-RED-A-B	14" X 10"
	304-14-12-CON-RED-A-B	14" X 12"
	304-16-12-CON-RED-A-B	16" X 12"
	304-16-14-CON-RED-A-B	16" X 14"
	304-18-14-CON-RED-A-B	18" X 14"
	304-18-16-CON-RED-A-B	18" X 16"
304-20-16-CON-RED-A-B	20" X 16"	
304-20-18-CON-RED-A-B	20" X 18"	
304-24-16-CON-RED-A-B	24" X 16"	
304-24-18-CON-RED-A-B	24" X 18"	
304-24-20-CON-RED-A-B	24" X 20"	

**STAINLESS STEEL PIPE SPOOLS
SECTION 2 - CATALOG PRICING**

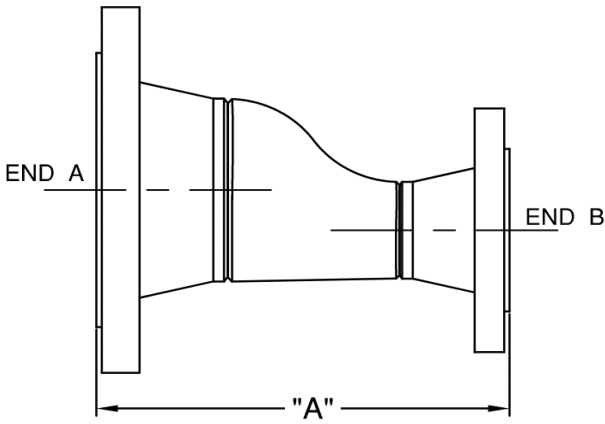
ECCENTRIC REDUCER	PART NUMBER	SIZE
 <p>END A</p> <p>END B</p> <p>"A"</p>	304-1-0.5-ECC-RED-A-B	1" x 1/2"
	304-2-1-ECC-RED-A-B	2" X 1"
	304-3-2-ECC-RED-A-B	3" X 2"
	304-4-2-ECC-RED-A-B	4" X 2"
	304-4-3-ECC-RED-A-B	4" X 3"
	304-6-3-ECC-RED-A-B	6" X 3"
	304-6-4-ECC-RED-A-B	6" X 4"
	304-8-3-ECC-RED-A-B	8" x 3"
	304-8-4-ECC-RED-A-B	8" X 4"
	304-8-6-ECC-RED-A-B	8" X 6"
	304-10-6-ECC-RED-A-B	10" X 6"
	304-10-8-ECC-RED-A-B	10" X 8"
	304-12-8-ECC-RED-A-B	12" X 8"
	304-12-10-ECC-RED-A-B	12" X 10"
	304-14-10-ECC-RED-A-B	14" X 10"
	304-14-12-ECC-RED-A-B	14" X 12"
	304-16-12-ECC-RED-A-B	16" X 12"
	304-16-14-ECC-RED-A-B	16" X 14"
	304-18-14-ECC-RED-A-B	18" X 14"
	304-18-16-ECC-RED-A-B	18" X 16"
	304-20-16-ECC-RED-A-B	20" X 16"
	304-20-18-ECC-RED-A-B	20" X 18"
	304-24-16-ECC-RED-A-B	24" X 16"
	304-24-18-ECC-RED-A-B	24" X 18"
304-24-20-ECC-RED-A-B	24" X 20"	

STAINLESS STEEL PIPE SPOOLS
SECTION 2 - CATALOG PRICING

REDUCING TEE

PART NUMBER

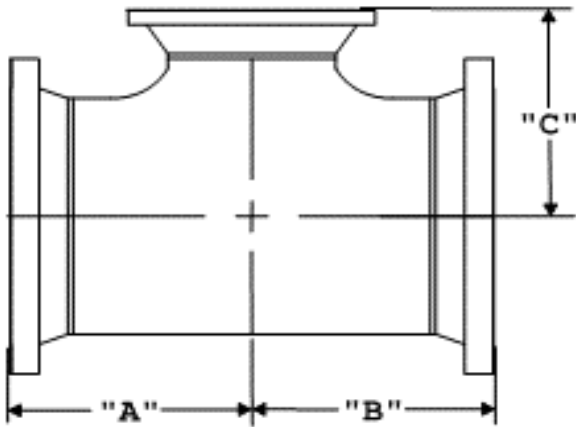

304-3-2-RT-A-B-C	3" X 2"
304-4-2-RT-A-B-C	4" X 2"
304-4-3-RT-A-B-C	4" X 3"
304-6-3-RT-A-B-C	6" X 3"
304-6-4-RT-A-B-C	6" X 4"
304-8-4-RT-A-B-C	8" X 4"
304-8-6-RT-A-B-C	8" X 6"
304-10-6-RT-A-B-C	10" X 6"
304-10-8-RT-A-B-C	10" X 8"
304-12-8-RT-A-B-C	12" X 8"
304-12-10-RT-A-B-C	12" X 10"
304-14-10-RT-A-B-C	14" X 10"
304-14-12-RT-A-B-C	14" X 12"
304-16-12-RT-A-B-C	16" X 12"
304-16-14-RT-A-B-C	16" X 14"
304-18-14-RT-A-B-C	18" X 14"
304-18-16-RT-A-B-C	18" X 16"
304-20-16-RT-A-B-C	20" X 16"
304-20-18-RT-A-B-C	20" X 18"
304-24-16-RT-A-B-C	24" X 16"
304-24-18-RT-A-B-C	24" X 18"
304-24-20-RT-A-B-C	24" X 20"

CROSS

PART NUMBER

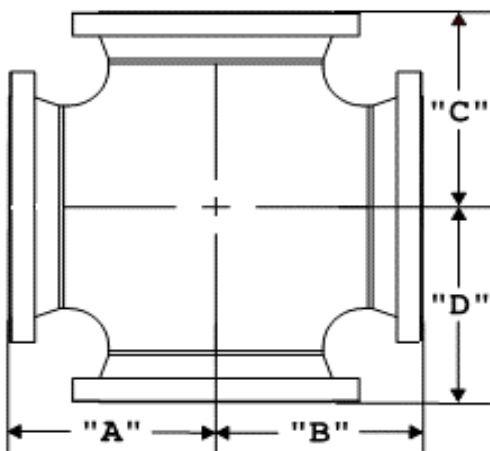

304-2-CRS-A-B-C-D	2"
304-3-CRS-A-B-C-D	3"
304-4-CRS-A-B-C-D	4"
304-6-CRS-A-B-C-D	6"
304-8-CRS-A-B-C-D	8"
304-10-CRS-A-B-C-D	10"
304-12-CRS-A-B-C-D	12"
304-14-CRS-A-B-C-D	14"
304-16-CRS-A-B-C-D	16"
304-18-CRS-A-B-C-D	18"
304-20-CRS-A-B-C-D	20"
304-24-CRS-A-B-C-D	24"

STAINLESS STEEL PIPE SPOOLS
SECTION 2 - CATALOG PRICING

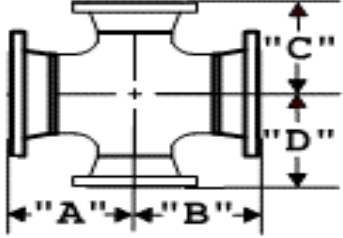
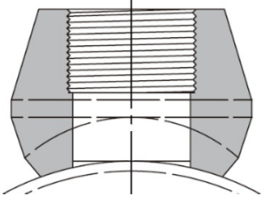
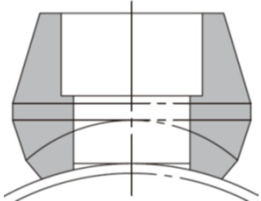
REDUCING CROSS	PART NUMBER	
	304-4-2-RC-A-B-C-D	4" X 2"
	304-4-3-A-B-C-D	4" X 3"
	304-6-3-RC-A-B-C-D	6" X 3"
	304-6-4-RC-A-B-C-D	6" X 4"
	304-8-4-RC-A-B-C-D	8" X 4"
	304-8-4-RC-A-B-C-D	8" X 6"
3000# THREAD-O-LET*	PART NUMBER	
	304-1/4-TOL-(LEG)-(DIS)-(ROT)	1/4"
	304-3/8-TOL-(LEG)-(DIS)-(ROT)	3/8"
	304-1/2-TOL-(LEG)-(DIS)-(ROT)	1/2"
	304-3/4-TOL-(LEG)-(DIS)-(ROT)	3/4"
	304-1-TOL-(LEG)-(DIS)-(ROT)	1"
	304-1 1/2-TOL-(LEG)-(DIS)-(ROT)	1-1/2"
304-2-TOL-(LEG)-(DIS)-(ROT)	2"	
3000# WELD-O-LET*		
	304-1-WOL-(LEG)-(DIS)-(ROT)	1"
	304-1 1/2-WOL-(LEG)-(DIS)-(ROT)	1-1/2"
	304-2-WOL-(LEG)-(DIS)-(ROT)	2"
	304-2 1/2-WOL-(LEG)-(DIS)-(ROT)	2-1/2"
	304-3-WOL-(LEG)-(DIS)-(ROT)	3"
	304-4-WOL-(LEG)-(DIS)-(ROT)	4"
304-6-WOL-(LEG)-(DIS)-(ROT)	6"	
PIPE PRICE PER INCH - TYPE 304/304L, SCH 10S		
		1/2"
		1"
		1-1/2"
		2"
		3"
		4"
		6"
		8"
		10"
		12"
		14"
		16"
		18"
		20"
		24"

**STAINLESS STEEL PIPE SPOOLS
SECTION 2 - CATALOG PRICING**

ADDITIONAL WELD COST PER EACH	
	1/2"
	1"
	1-1/2"
	2"
	3"
	4"
	6"
	8"
	10"
	12"
	14"
	16"
	18"
	20"
	24"

PASSIVATION PER WELD**	
	1/2" - 4" Joints
	6" - 12" Joints
	14" - 18" Joints
	20" - 24" Joints

CONTAINMENT BASIN - 304 SST*	PART NUMBER
*FULL DETAIL DRAWINGS AVAILABLE	CB-304-52-60-25 52"X60"X25"

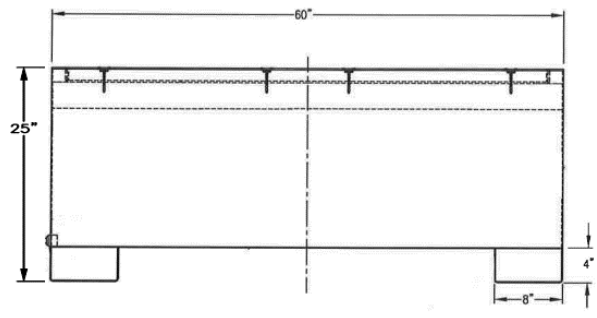

STAINLESS STEEL PIPE SPOOLS SECTION 2 - CATALOG PRICING

PIPE SPOOL WITH VERTICAL OFFSET	PART NUMBER
*FULL DETAIL DRAWINGS AVAILABLE UPON REQUEST	304-4-PS-36-V2+8-LJ 4"

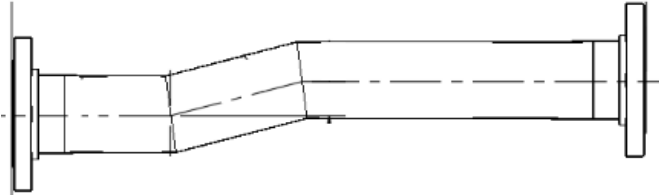

See notes in Section 4 for assistance in using this catalog.

*O-Lets will be a sub number on the line below the spool to be welded into.

**Passivation Notes, Item 15 in Section 4 - Notes.

STAINLESS STEEL PIPE SPOOLS SECTION 3 - FITTING DIMENSION DRAWINGS

45 DEGREE ELBOW - WITH 150# RAISED FACE WELD NECK FLANGES

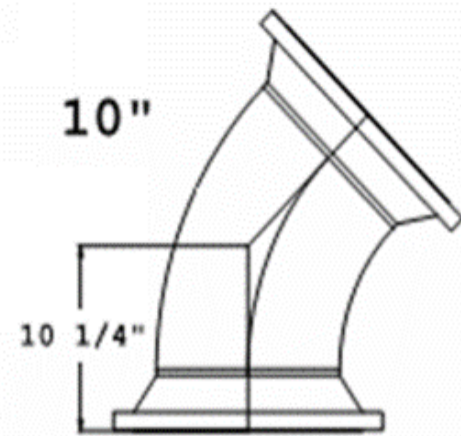
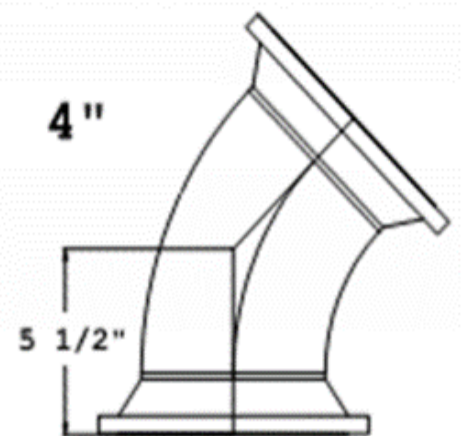
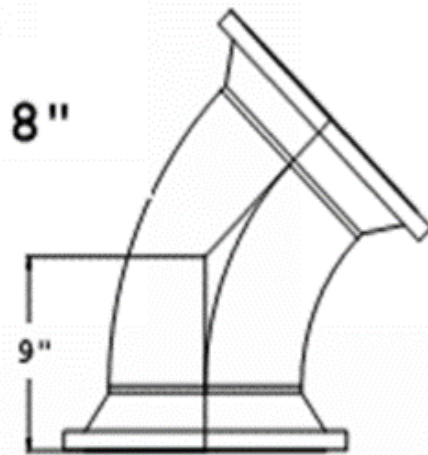
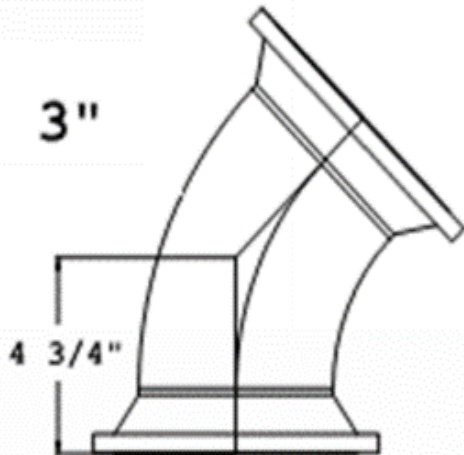
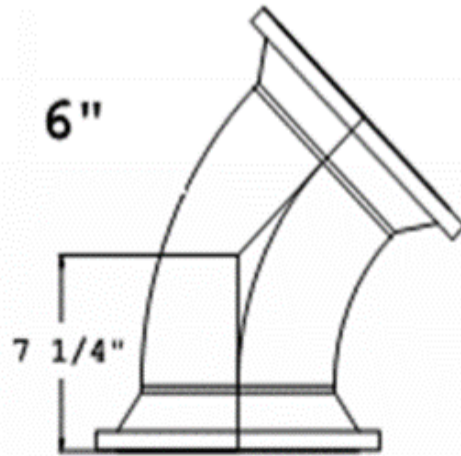
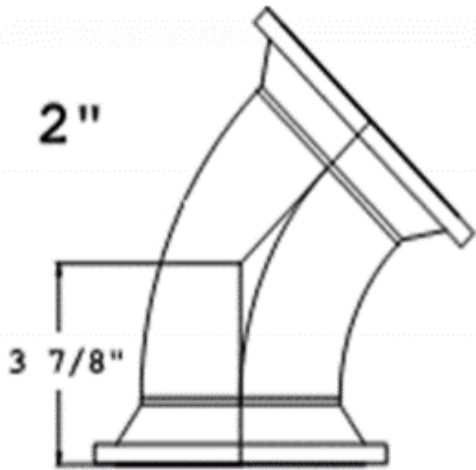

STAINLESS STEEL PIPE SPOOLS SECTION 3 - FITTING DIMENSION DRAWINGS

45 DEGREE ELBOW - WITH 150# RAISED FACE WELD NECK FLANGES

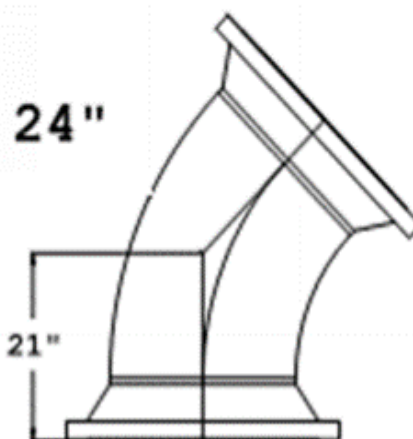
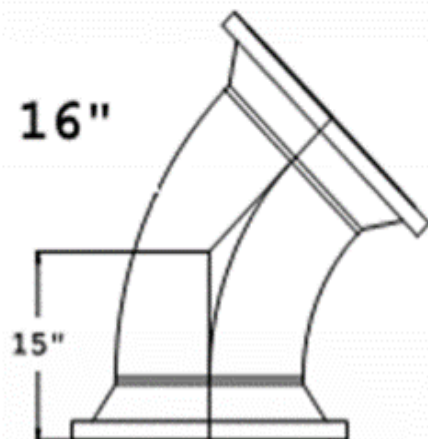
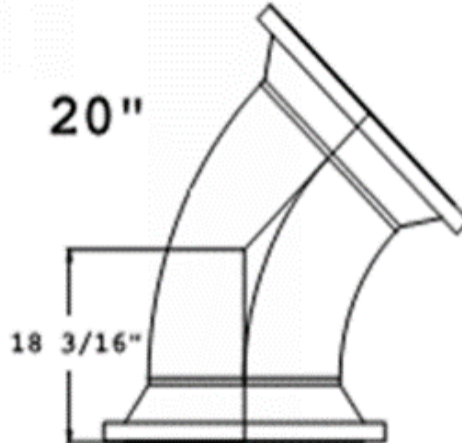
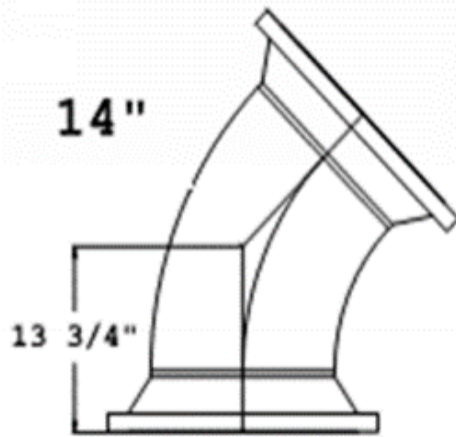
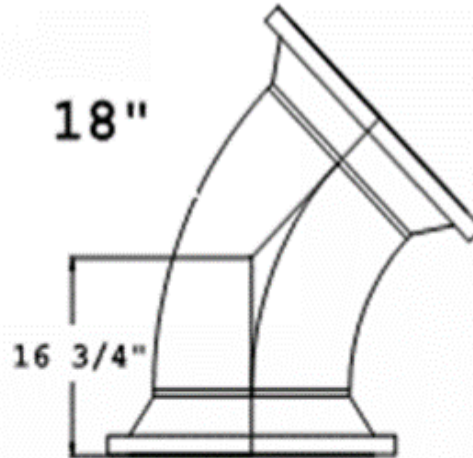
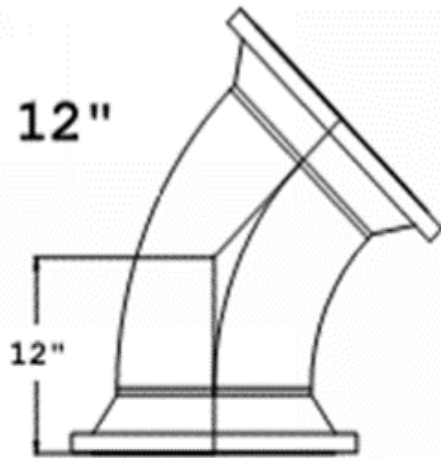

STAINLESS STEEL PIPE SPOOLS
SECTION 3 - FITTING DIMENSION DRAWINGS

90 DEGREE ELBOW - SHORT RADIUS WITH 150# RAISED FACE WELD NECK FLANGES

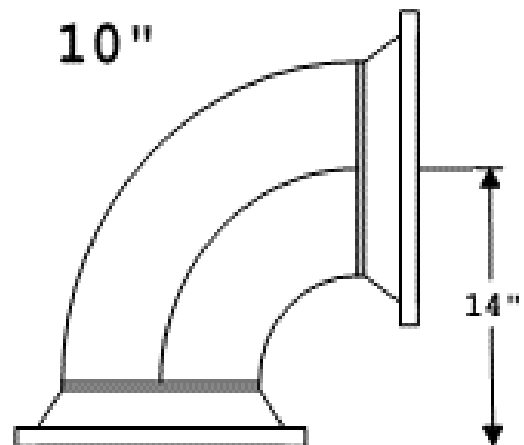
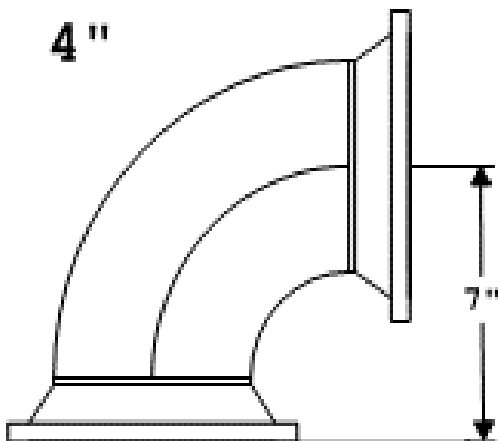
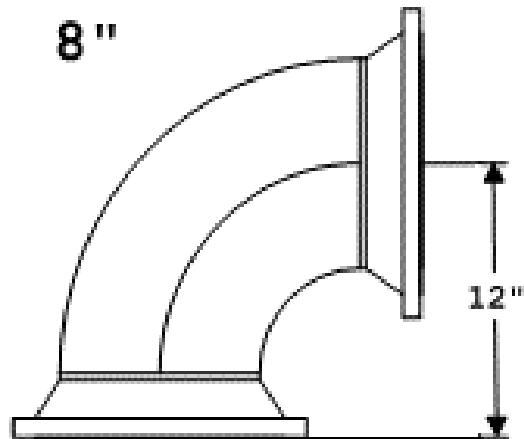
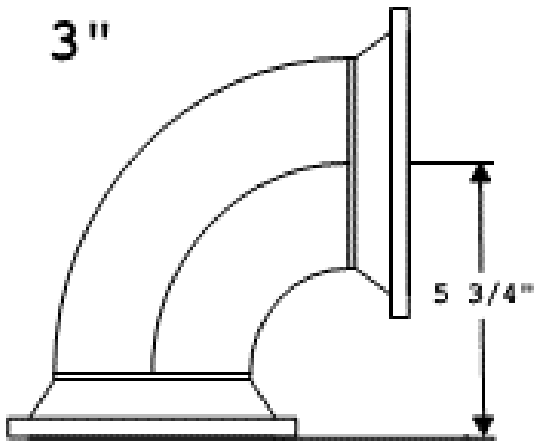
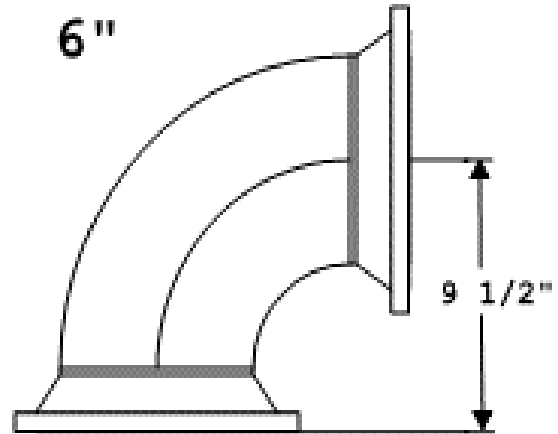
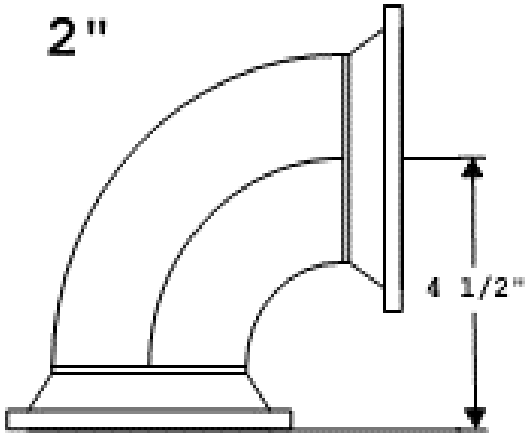

STAINLESS STEEL PIPE SPOOLS
SECTION 3 - FITTING DIMENSION DRAWINGS

90 DEGREE ELBOW - SHORT RADIUS WITH 150# RAISED FACE WELD NECK FLANGES

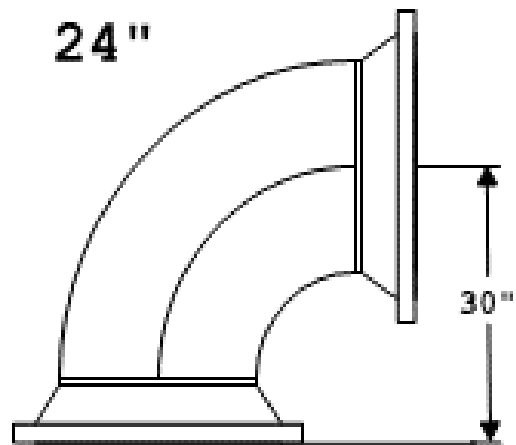
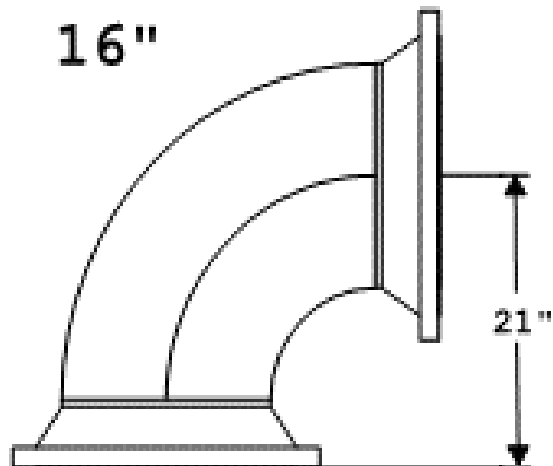
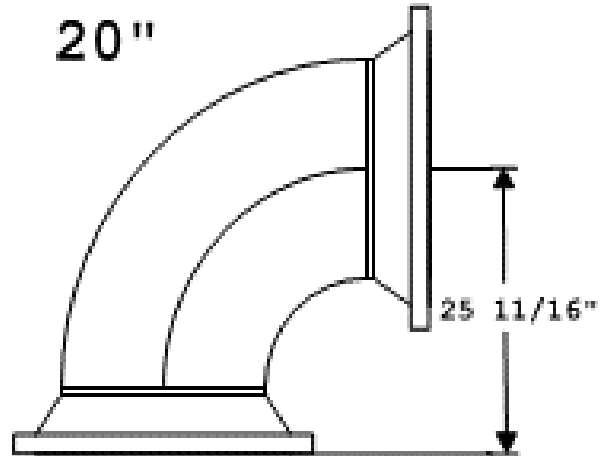
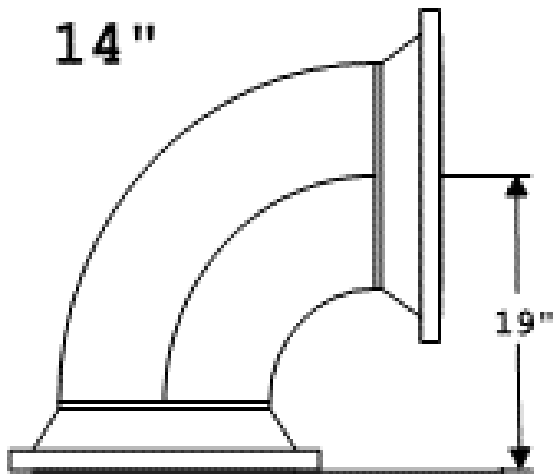
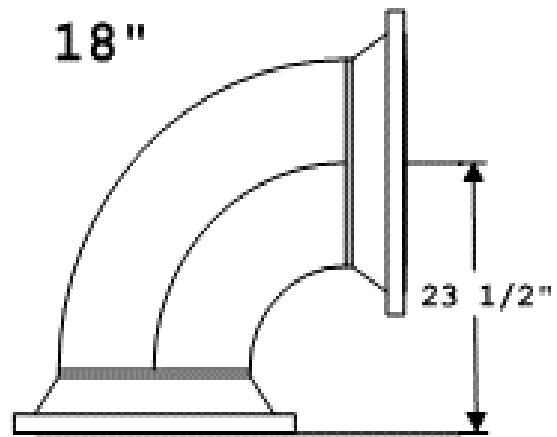
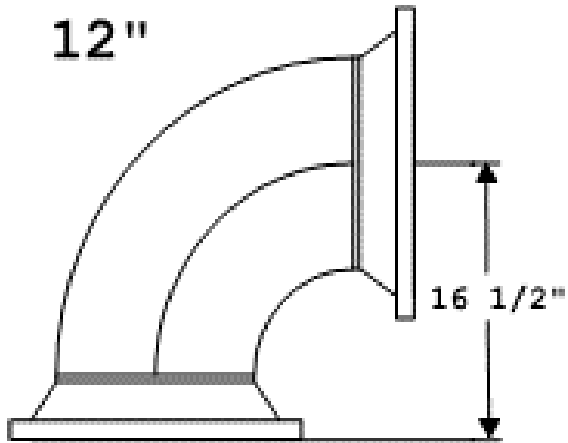

STAINLESS STEEL PIPE SPOOLS SECTION 3 - FITTING DIMENSION DRAWINGS

90 DEGREE ELBOW - LONG RADIUS WITH 150# RAISED FACE WELD NECK FLANGES

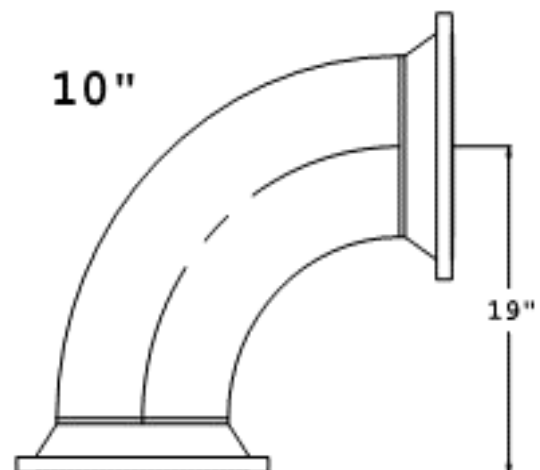
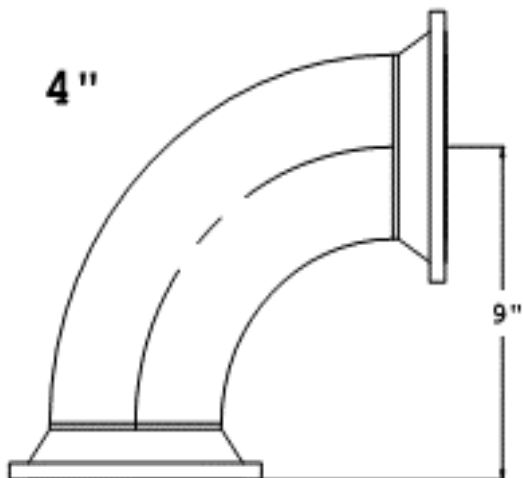
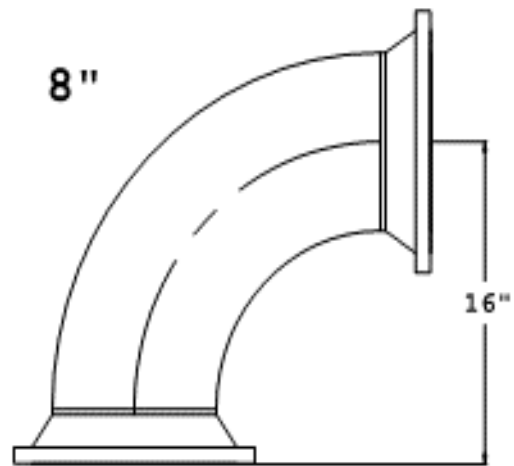
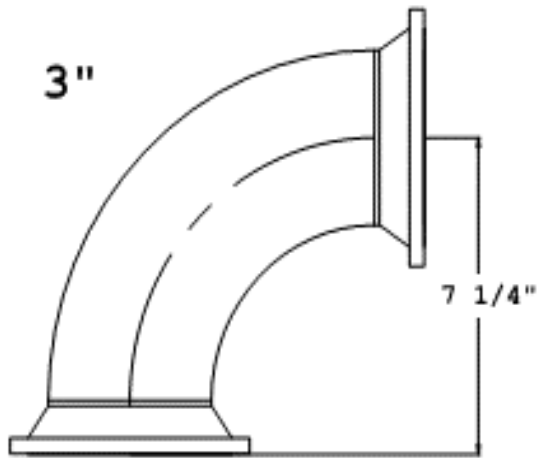
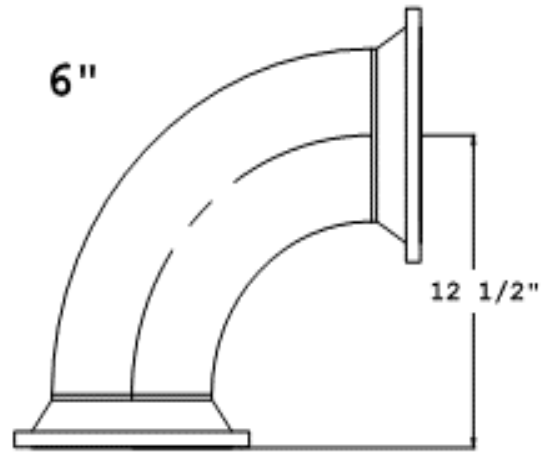
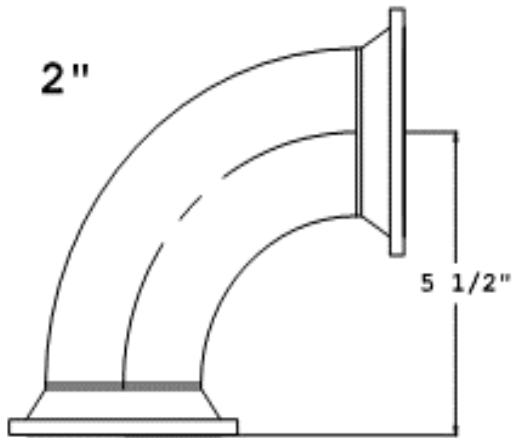

STAINLESS STEEL PIPE SPOOLS
SECTION 3 - FITTING DIMENSION DRAWINGS

90 DEGREE ELBOW - LONG RADIUS WITH 150# RAISED FACE WELD NECK FLANGES

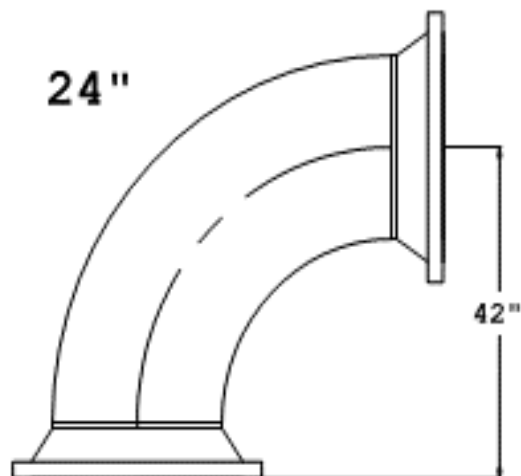
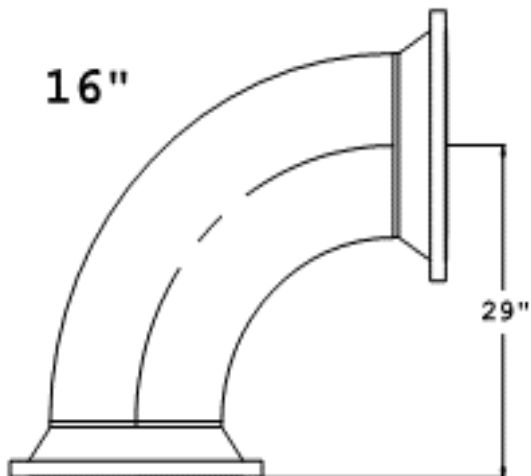
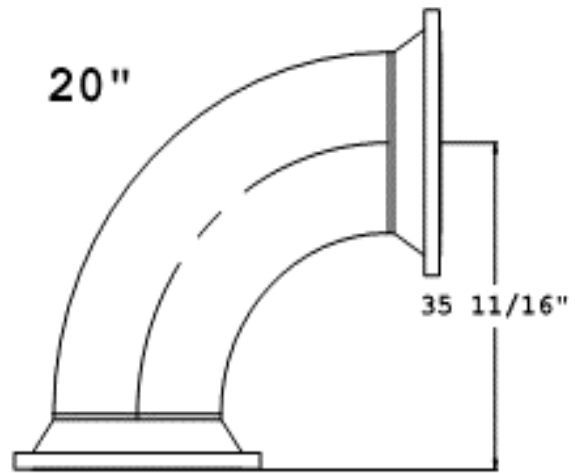
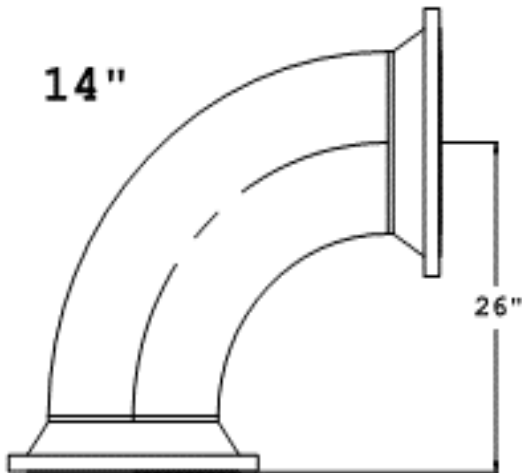
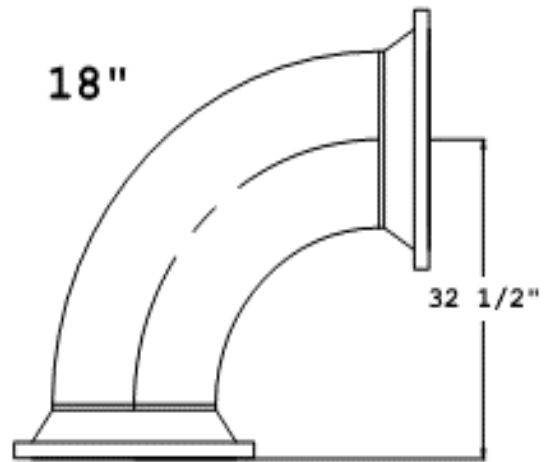
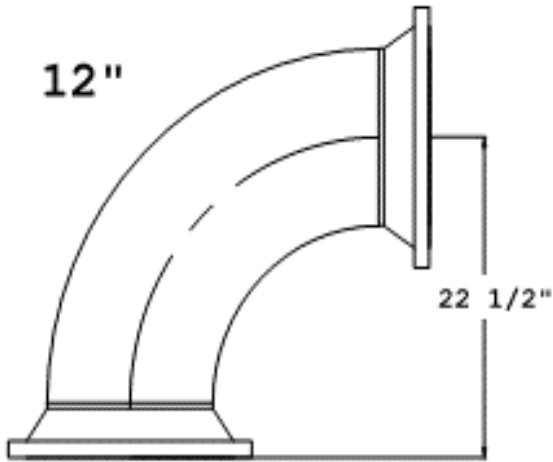

STAINLESS STEEL PIPE SPOOLS
SECTION 3 - FITTING DIMENSION DRAWINGS

TEE WITH 150# RAISED FACE WELD NECK FLANGES

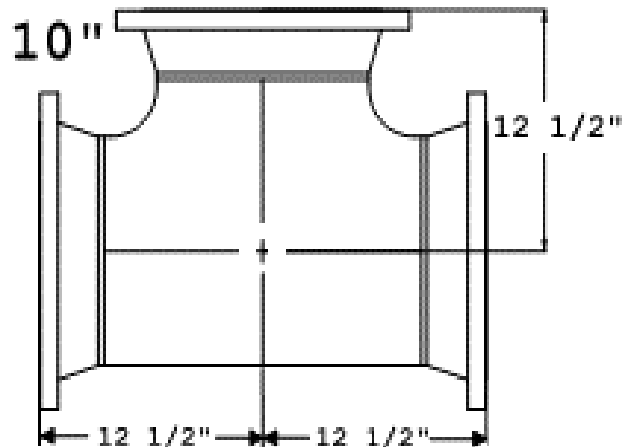
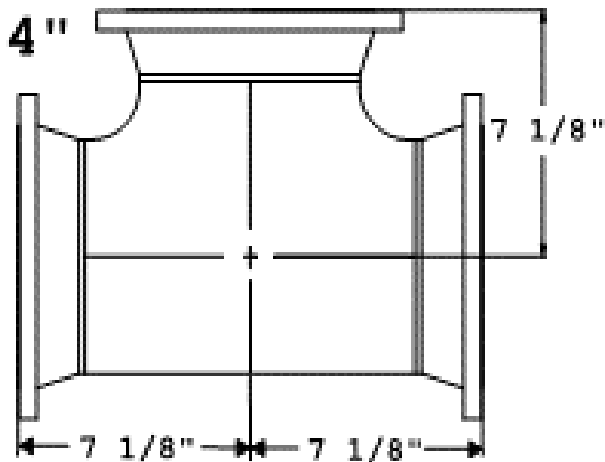
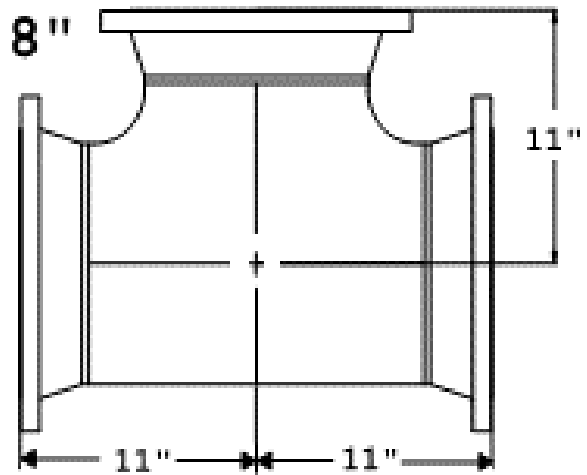
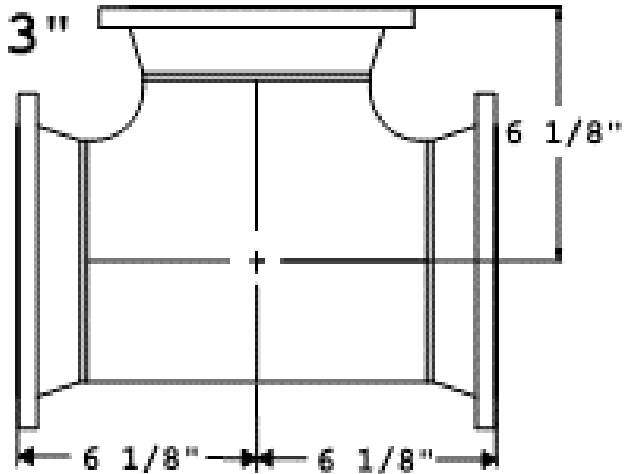
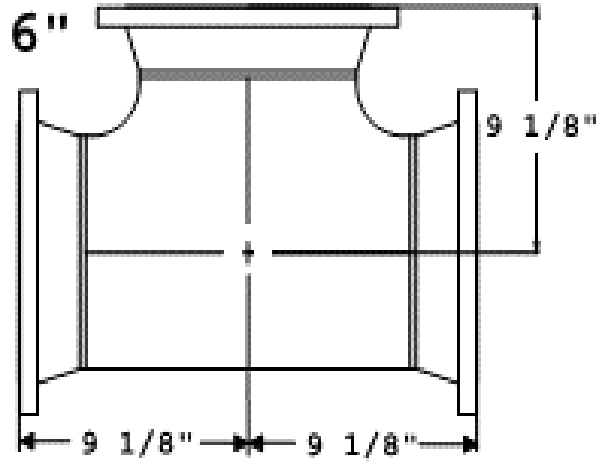
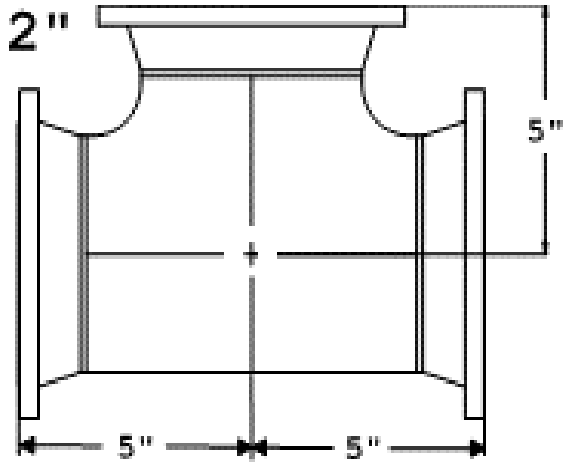

STAINLESS STEEL PIPE SPOOLS
SECTION 3 - FITTING DIMENSION DRAWINGS

TEE WITH 150# RAISED FACE WELD NECK FLANGES

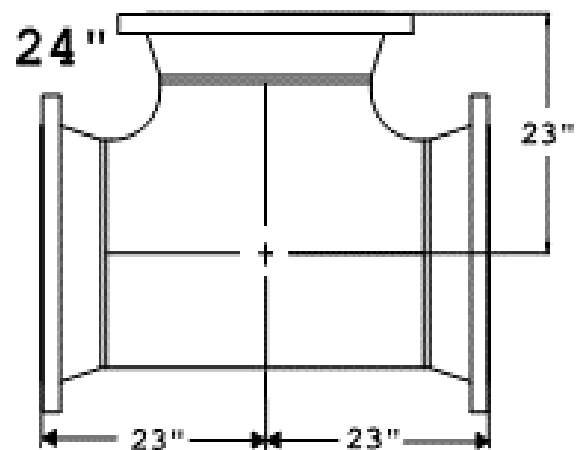
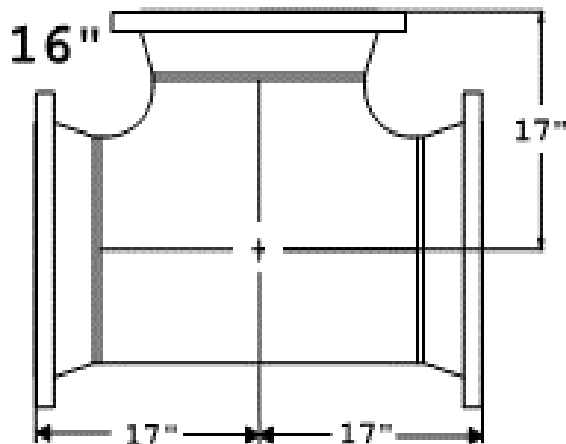
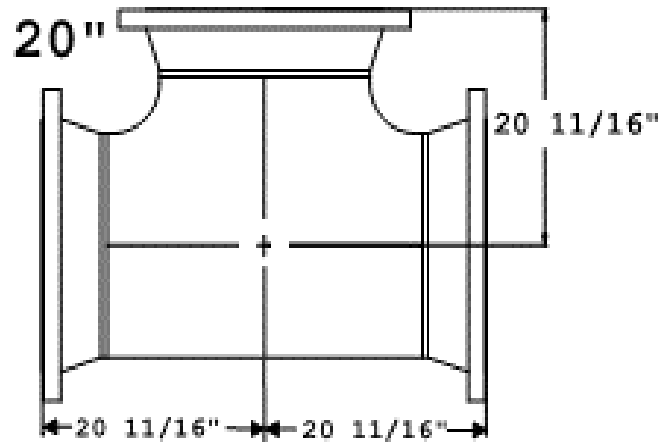
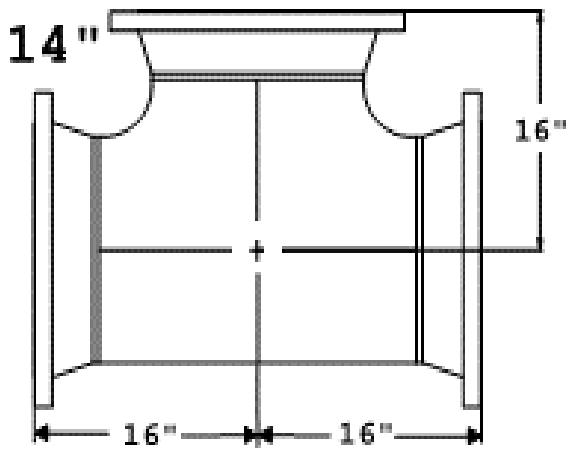
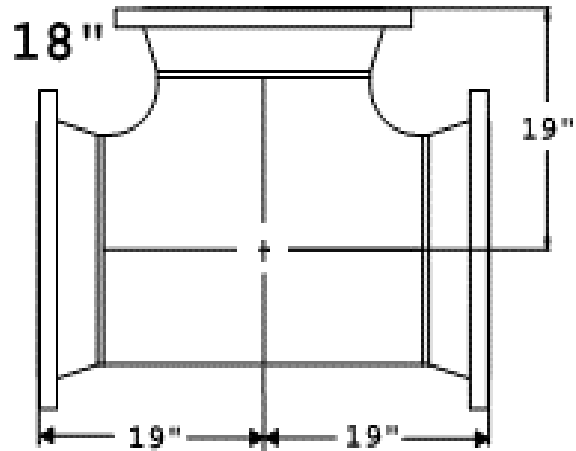
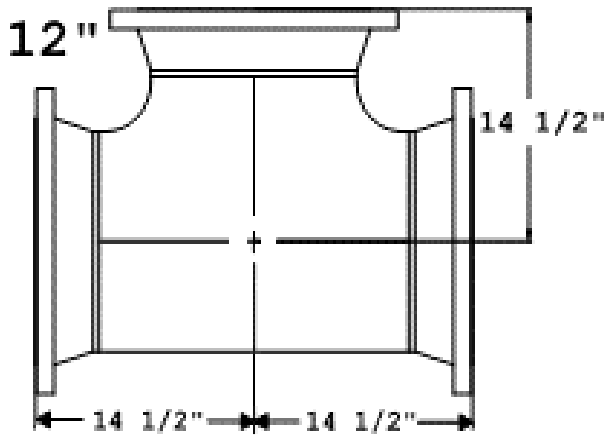

STAINLESS STEEL PIPE SPOOLS
SECTION 3 - FITTING DIMENSION DRAWINGS

REDUCING TEE WITH 150# RAISED FACE WELD NECK FLANGES

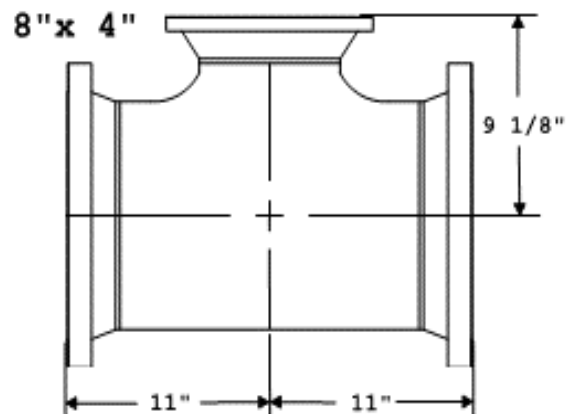
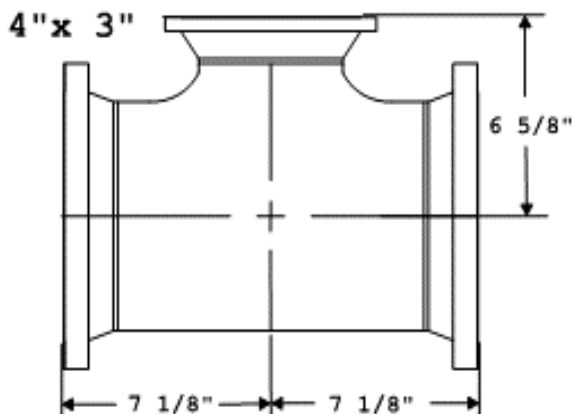
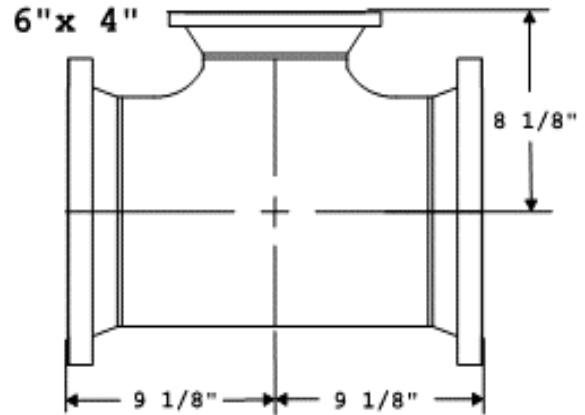
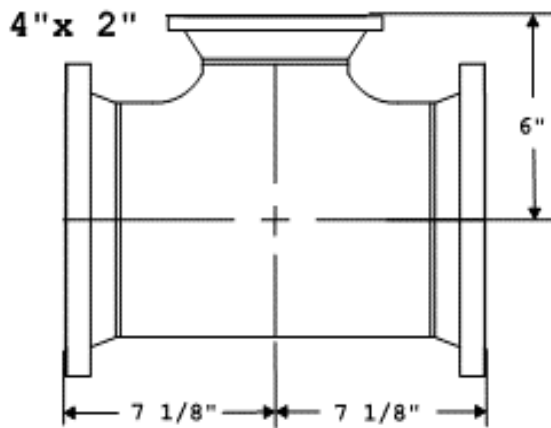
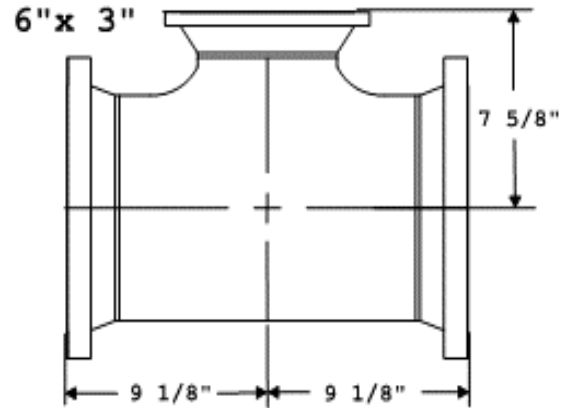
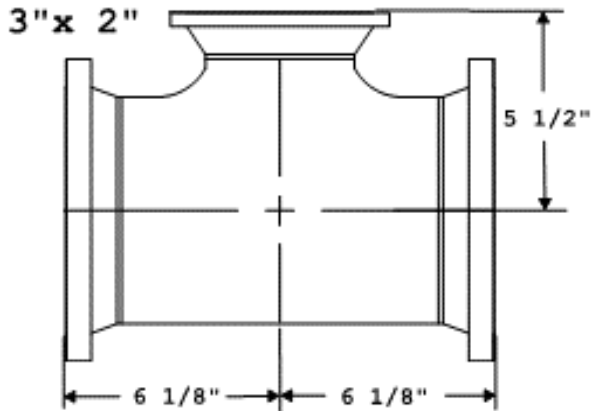

STAINLESS STEEL PIPE SPOOLS SECTION 3 - FITTING DIMENSION DRAWINGS

REDUCING TEE WITH 150# RAISED FACE WELD NECK FLANGES

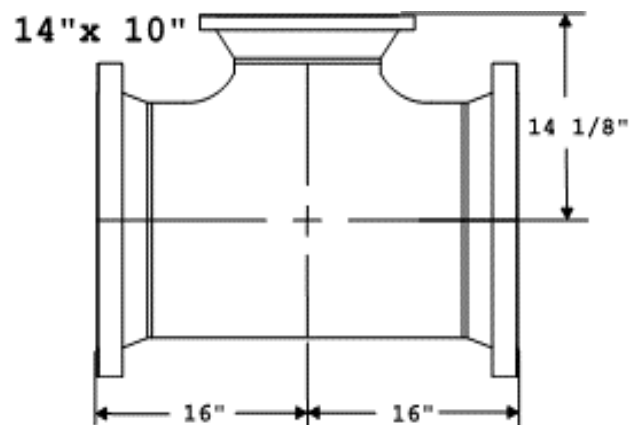
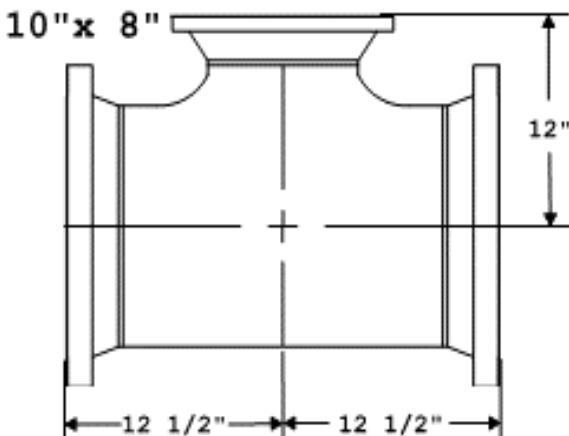
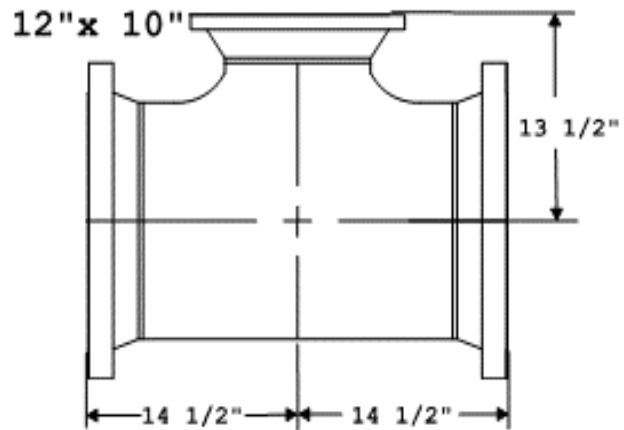
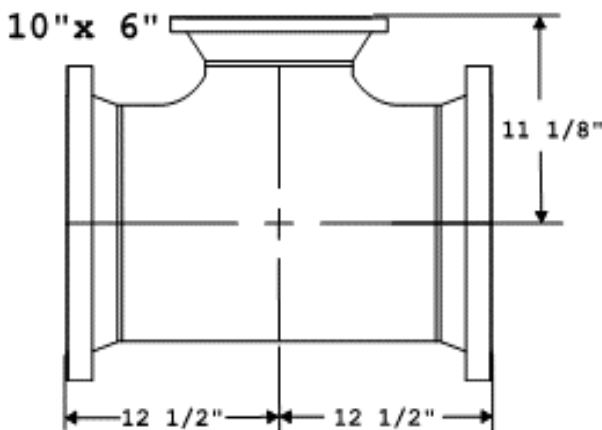
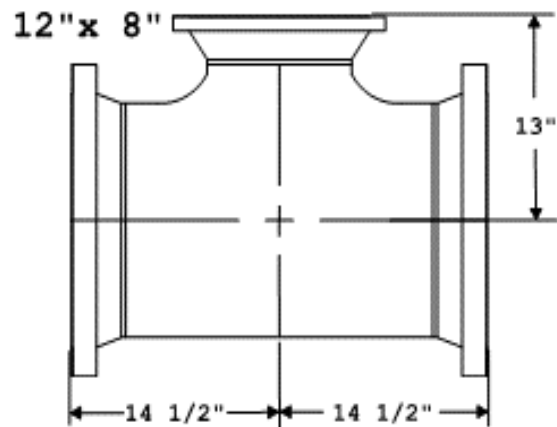
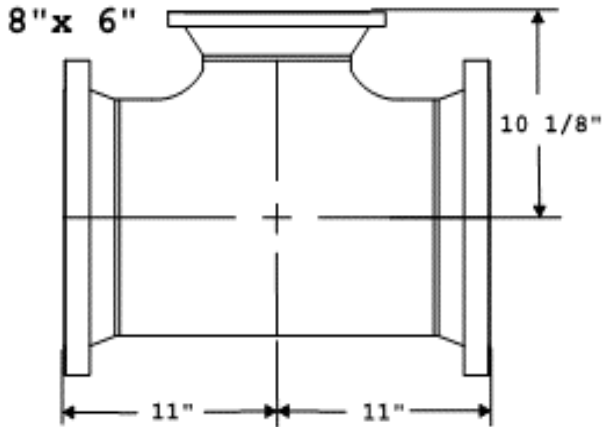

STAINLESS STEEL PIPE SPOOLS
SECTION 3 - FITTING DIMENSION DRAWINGS

REDUCING TEE WITH 150# RAISED FACE WELD NECK FLANGES

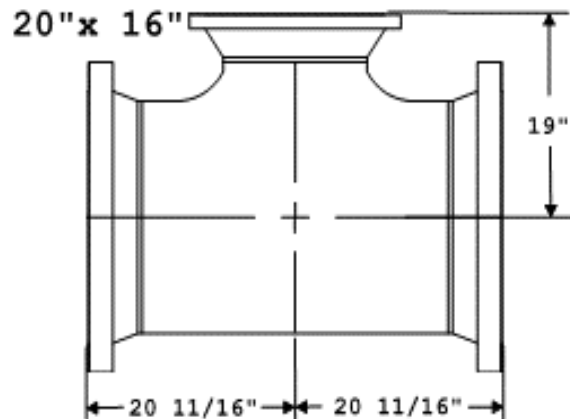
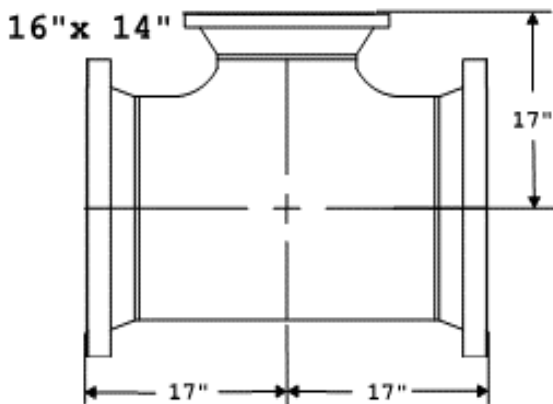
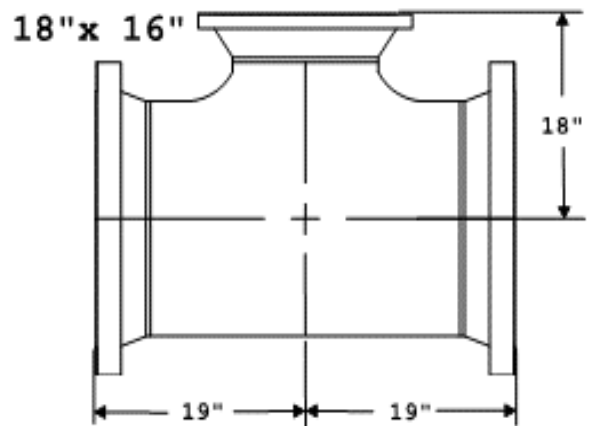
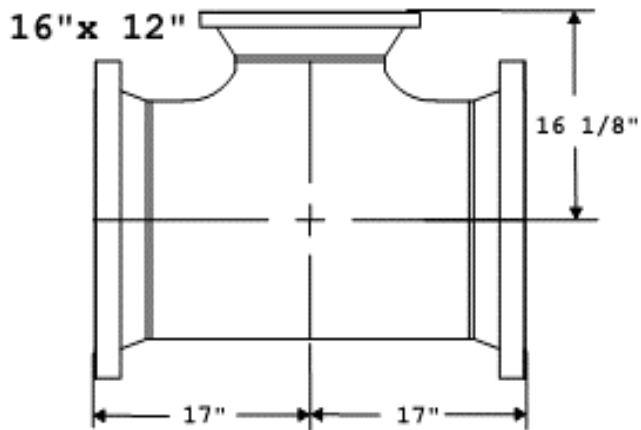
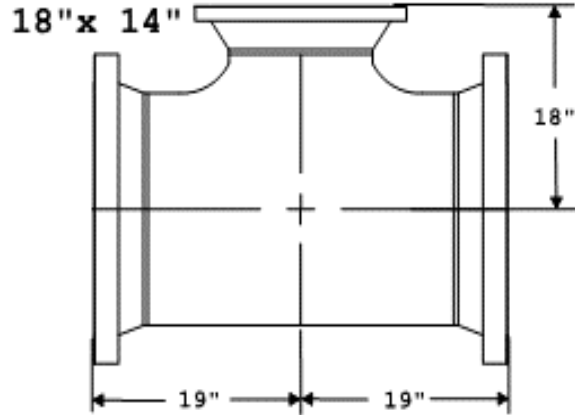
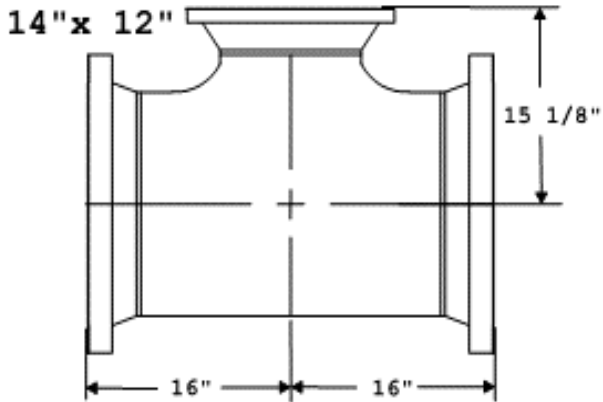

STAINLESS STEEL PIPE SPOOLS
SECTION 3 - FITTING DIMENSION DRAWINGS

REDUCING TEE WITH 150# RAISED FACE WELD NECK FLANGES

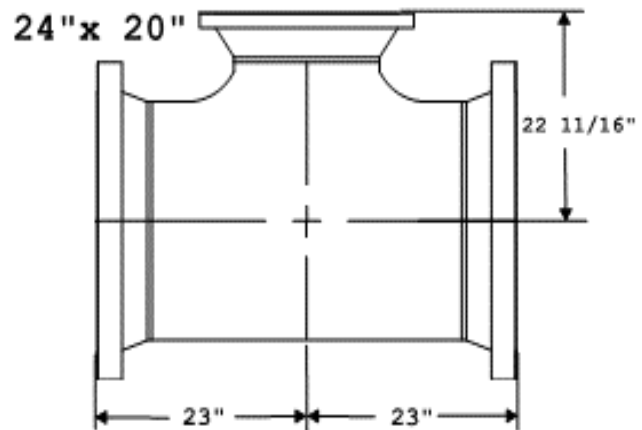
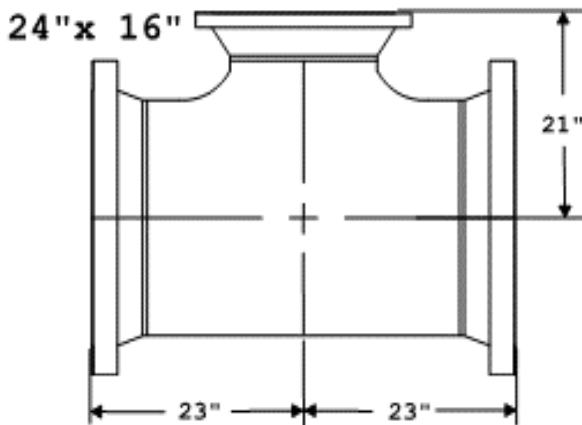
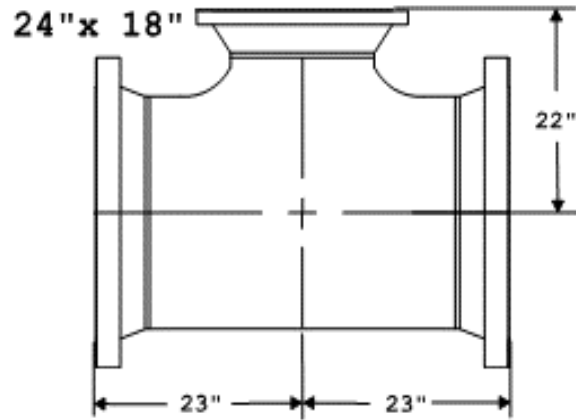
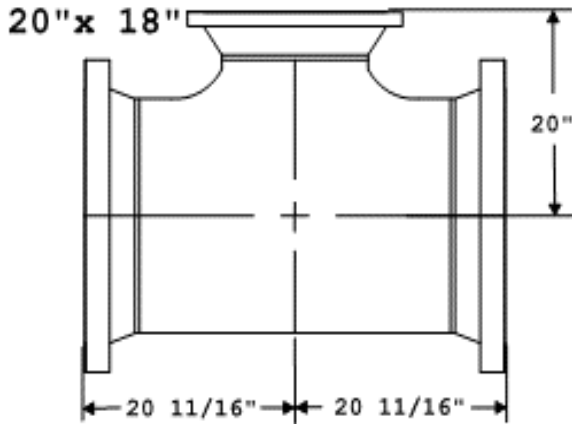

CONCENTRIC REDUCERS WITH 150# RAISED FACE WELD NECK FLANGES

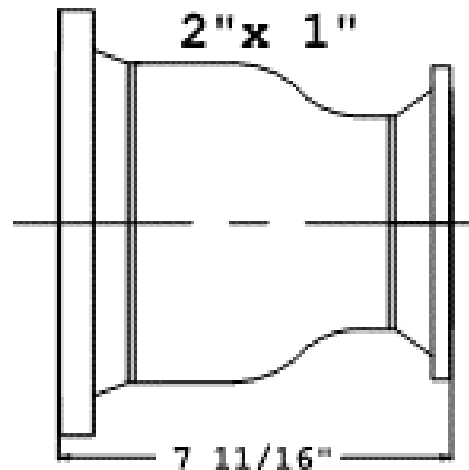
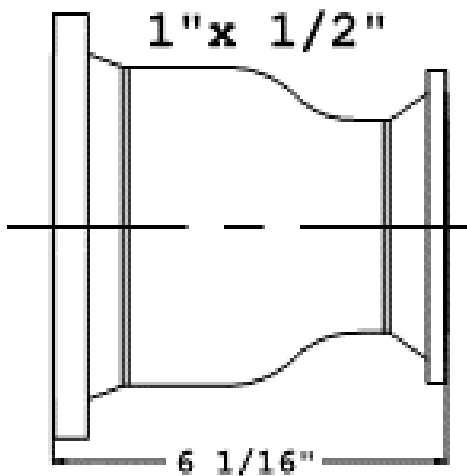

STAINLESS STEEL PIPE SPOOLS SECTION 3 - FITTING DIMENSION DRAWINGS

CONCENTRIC REDUCERS WITH 150# RAISED FACE WELD NECK FLANGES

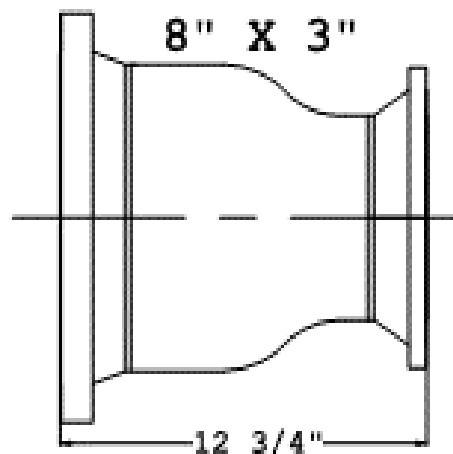
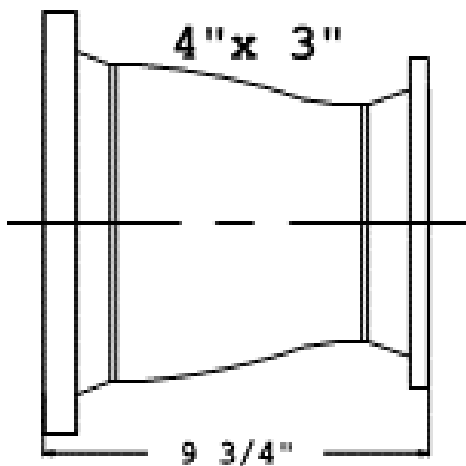
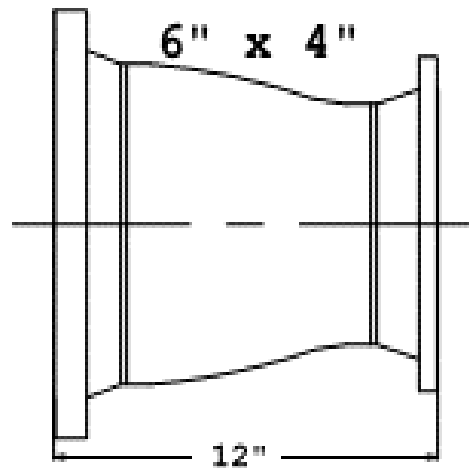
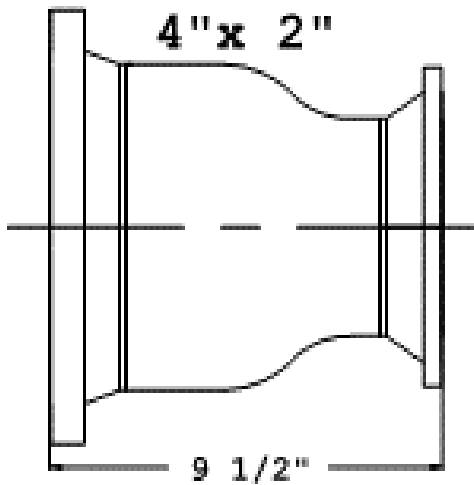
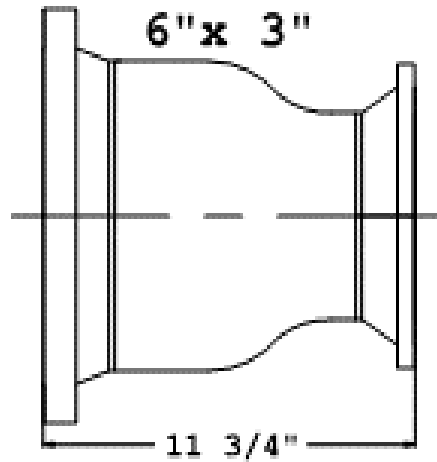
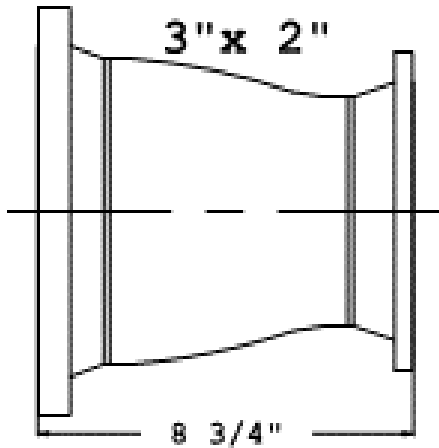

STAINLESS STEEL PIPE SPOOLS
SECTION 3 - FITTING DIMENSION DRAWINGS

CONCENTRIC REDUCERS WITH 150# RAISED FACE WELD NECK FLANGES

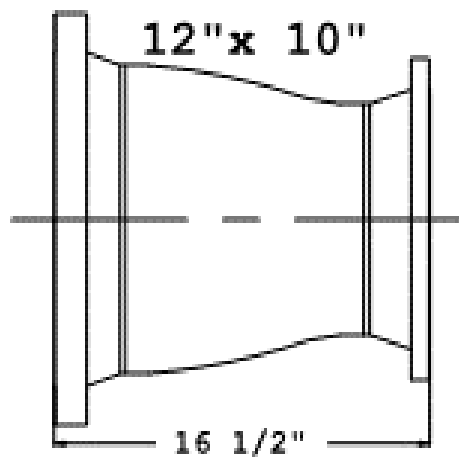
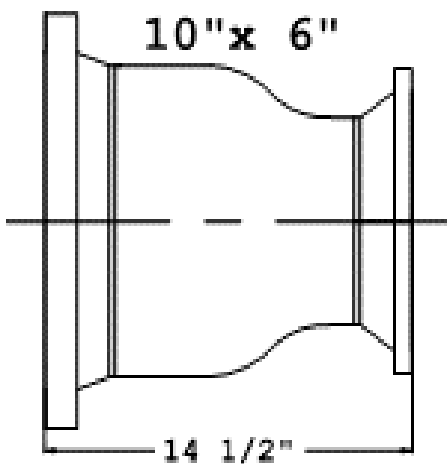
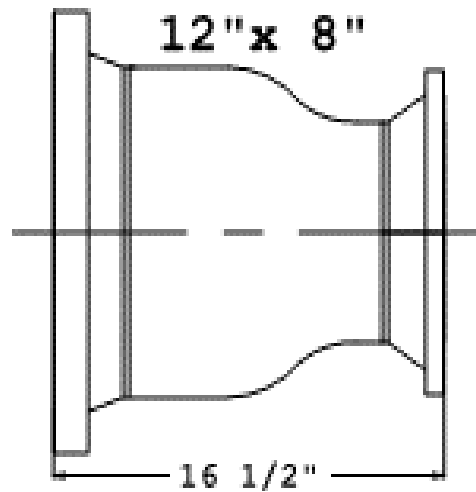
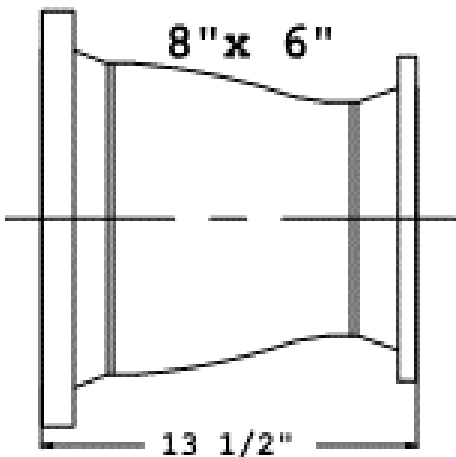
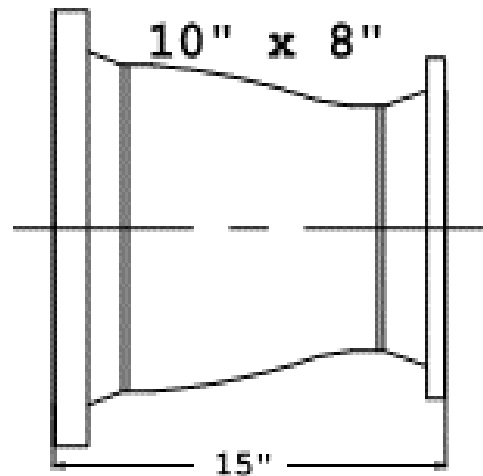
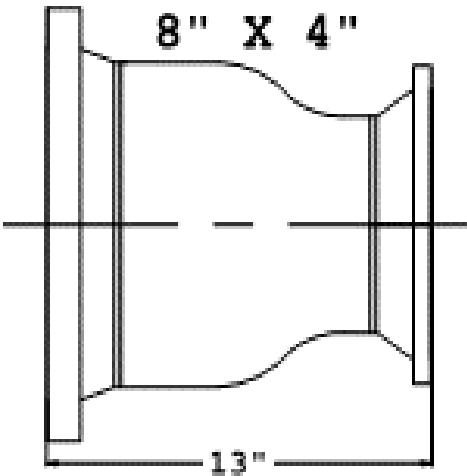

STAINLESS STEEL PIPE SPOOLS SECTION 3 - FITTING DIMENSION DRAWINGS

CONCENTRIC REDUCERS WITH 150# RAISED FACE WELD NECK FLANGES

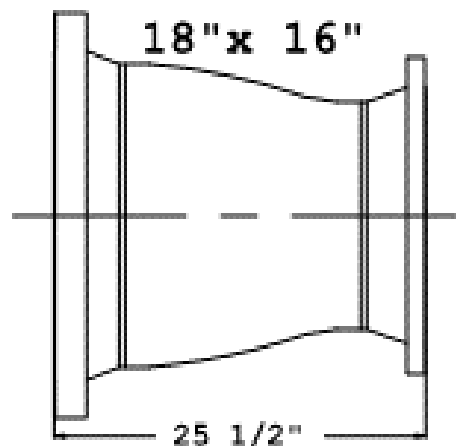
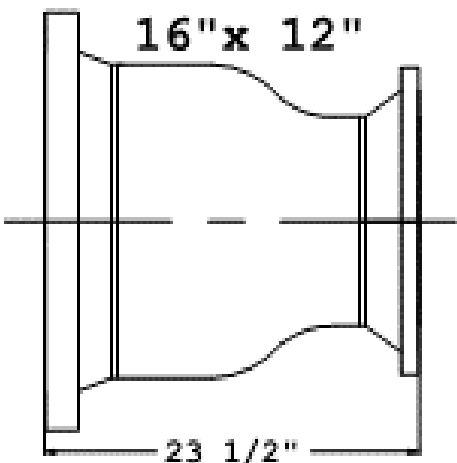
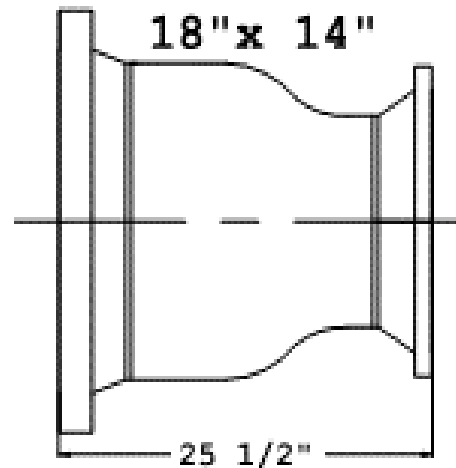
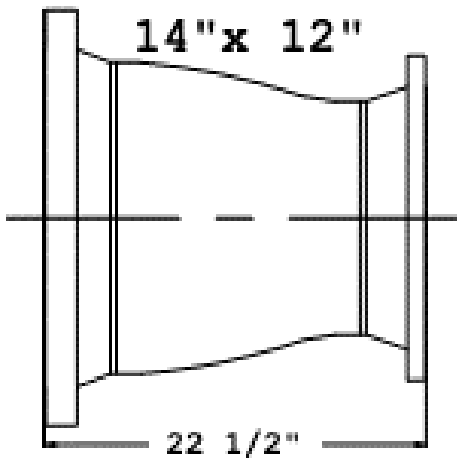
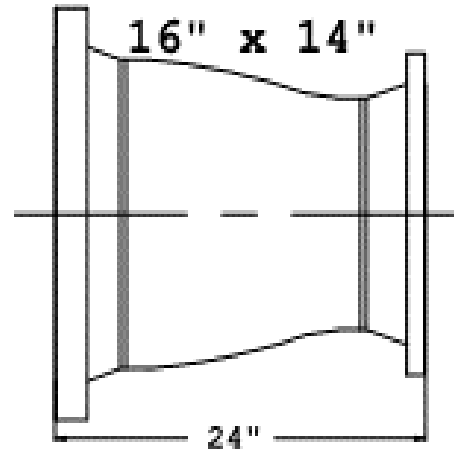
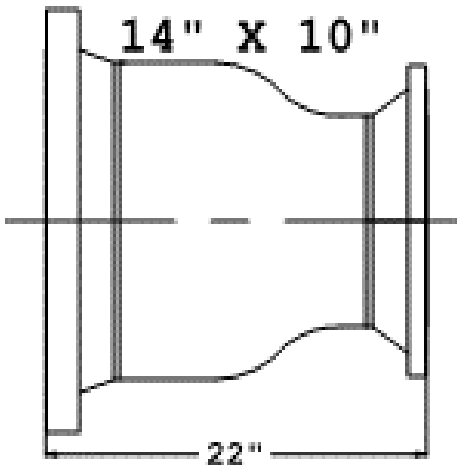

STAINLESS STEEL PIPE SPOOLS SECTION 3 - FITTING DIMENSION DRAWINGS

CONCENTRIC REDUCERS WITH 150# RAISED FACE WELD NECK FLANGES

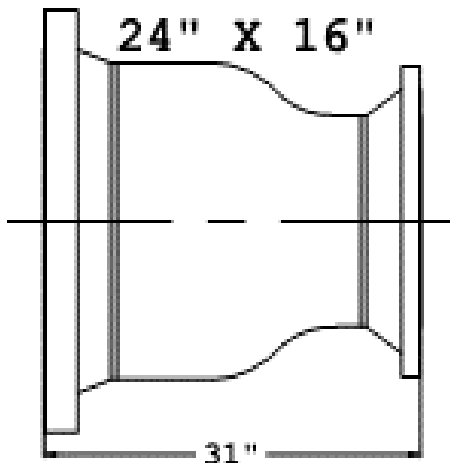
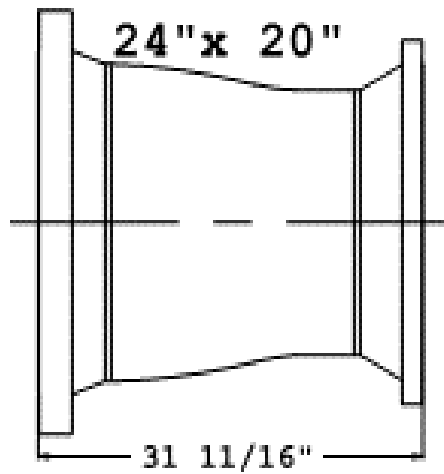
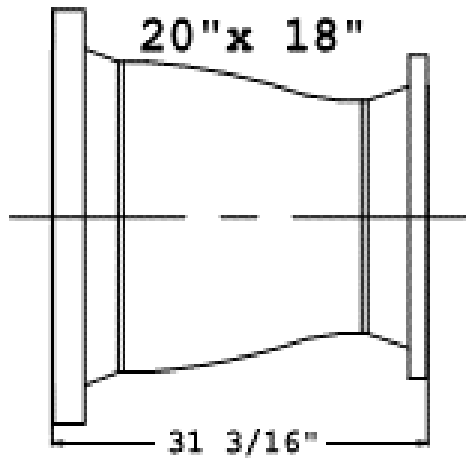
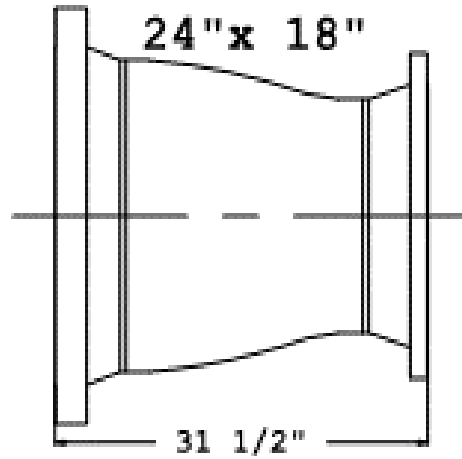
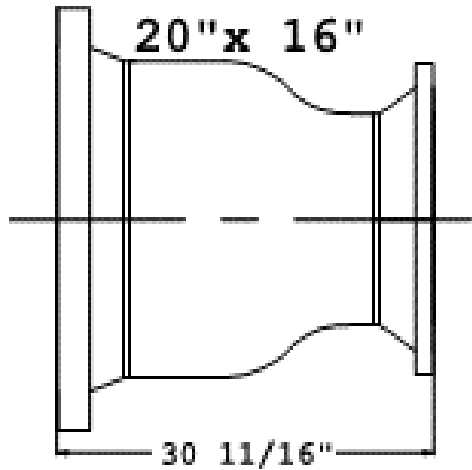

STAINLESS STEEL PIPE SPOOLS SECTION 3 - FITTING DIMENSION DRAWINGS

ECCENTRIC REDUCERS WITH 150# RAISED FACE WELD NECK FLANGES

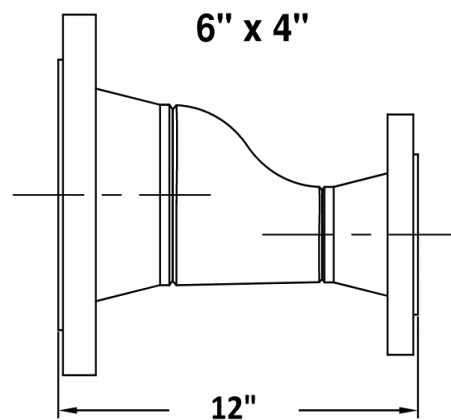
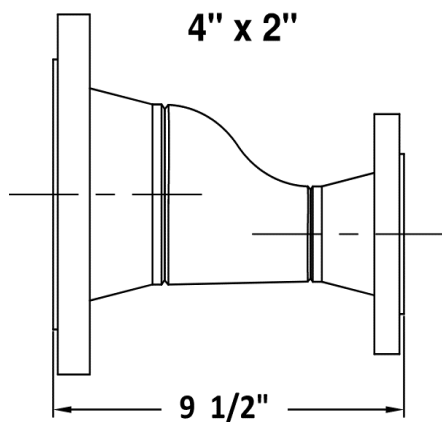
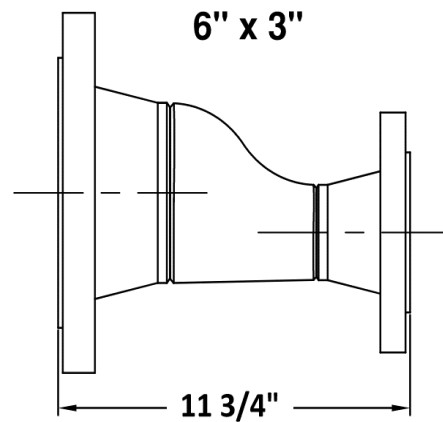
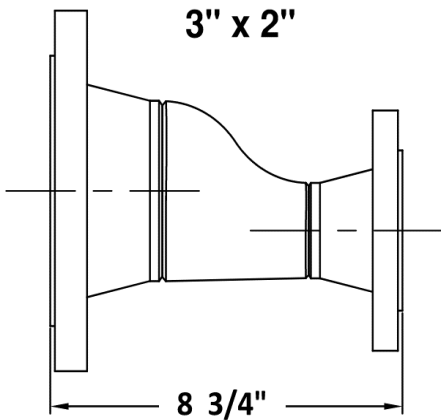
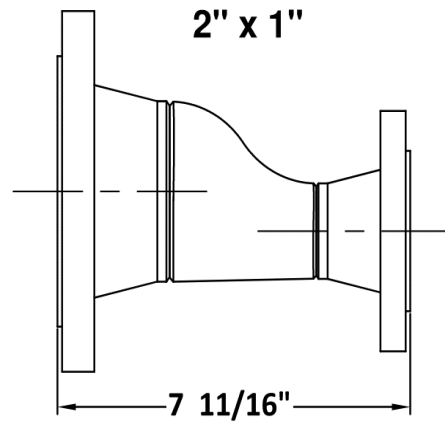
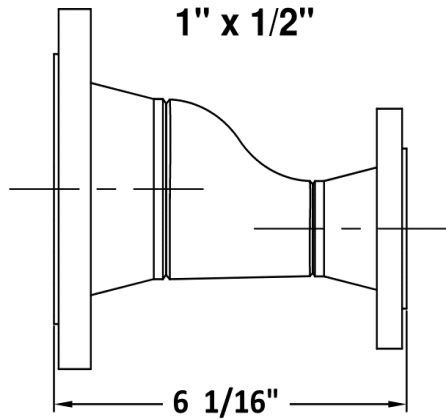

STAINLESS STEEL PIPE SPOOLS SECTION 3 - FITTING DIMENSION DRAWINGS

ECCENTRIC REDUCERS WITH 150# RAISED FACE WELD NECK FLANGES

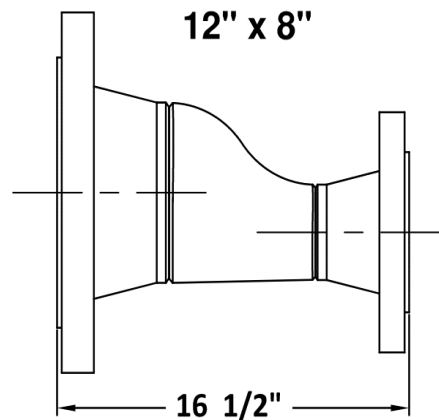
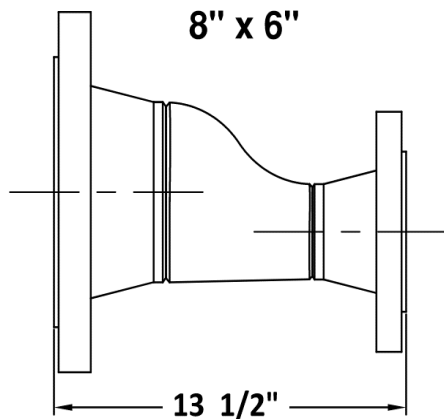
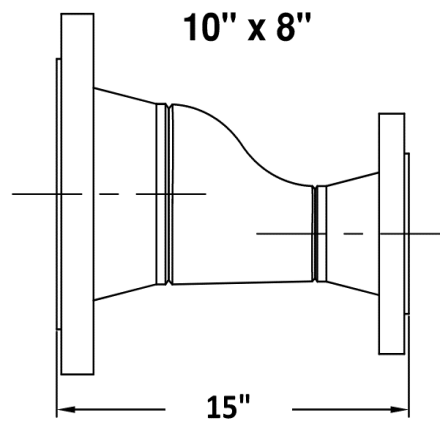
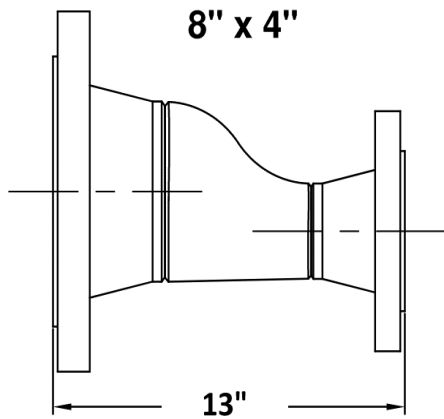
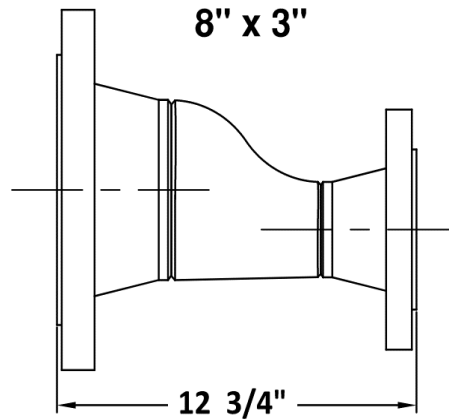
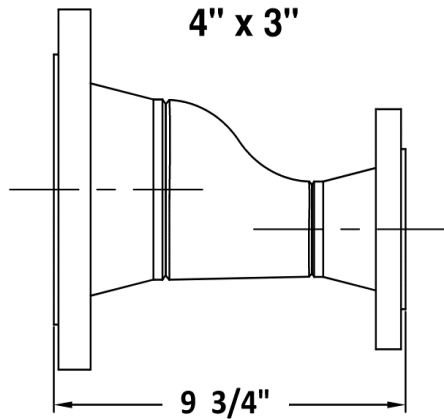

STAINLESS STEEL PIPE SPOOLS SECTION 3 - FITTING DIMENSION DRAWINGS

ECCENTRIC REDUCERS WITH 150# RAISED FACE WELD NECK FLANGES

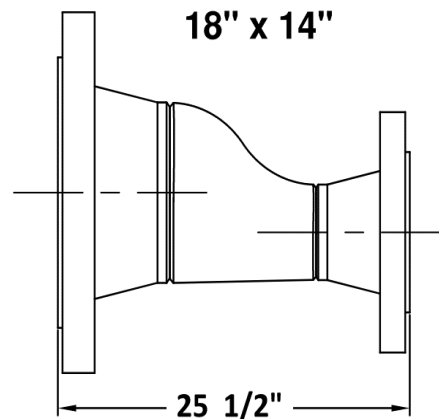
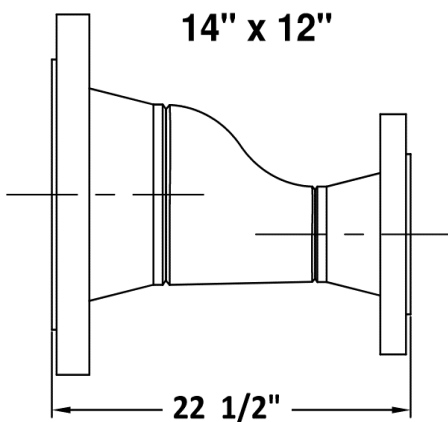
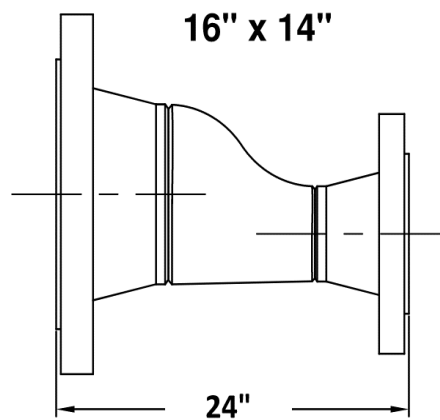
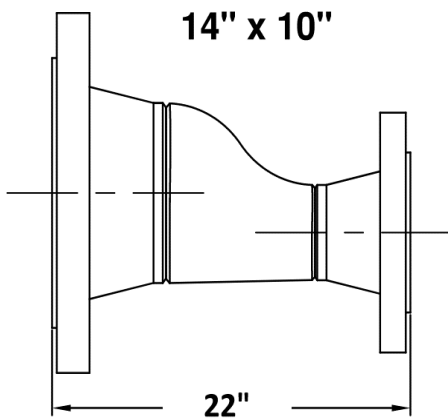
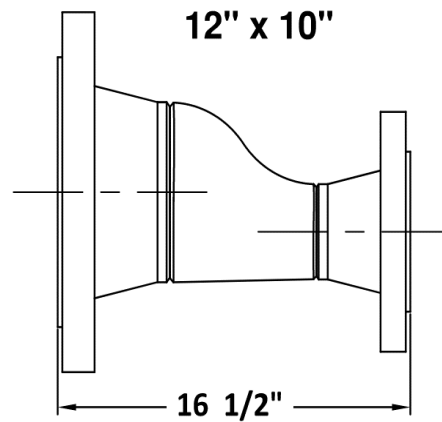
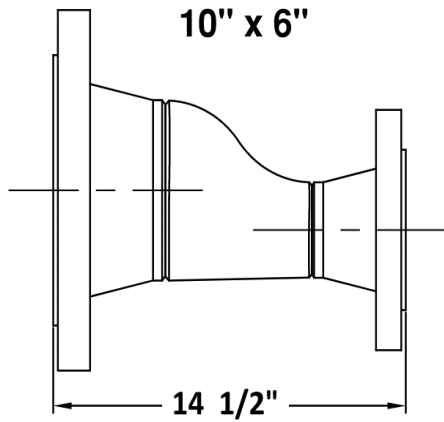

STAINLESS STEEL PIPE SPOOLS SECTION 3 - FITTING DIMENSION DRAWINGS

ECCENTRIC REDUCERS WITH 150# RAISED FACE WELD NECK FLANGES

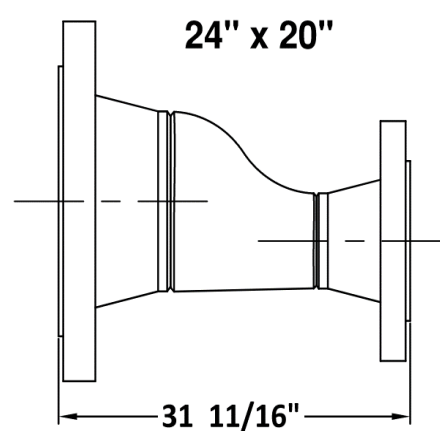
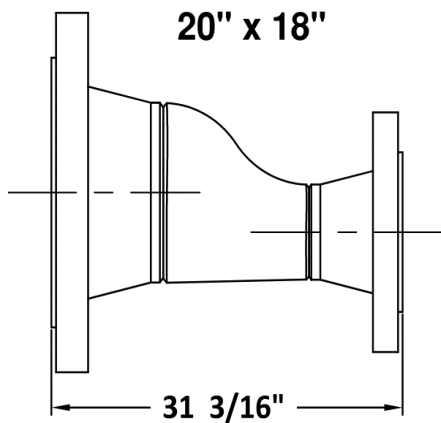
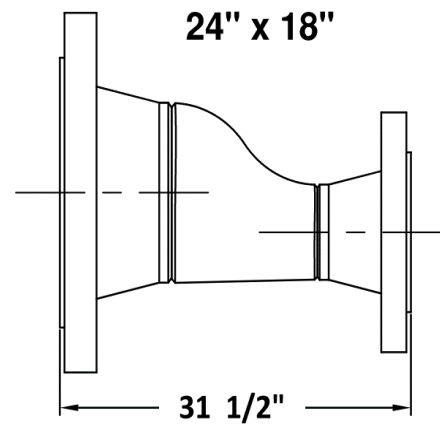
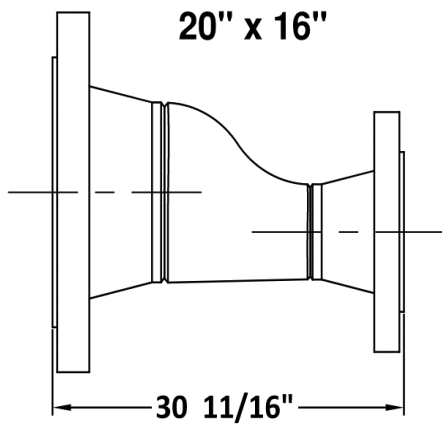
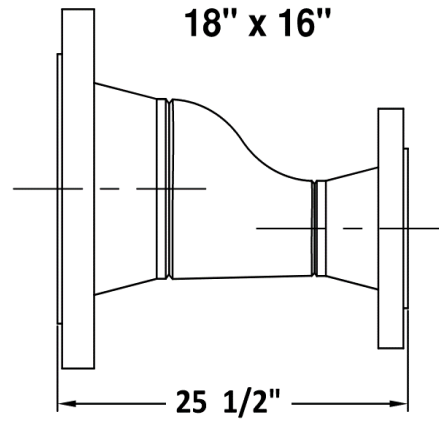
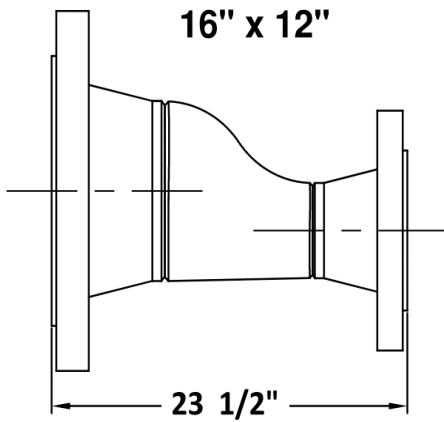

STAINLESS STEEL PIPE SPOOLS SECTION 3 - FITTING DIMENSION DRAWINGS

ECCENTRIC REDUCERS WITH 150# RAISED FACE WELD NECK FLANGES

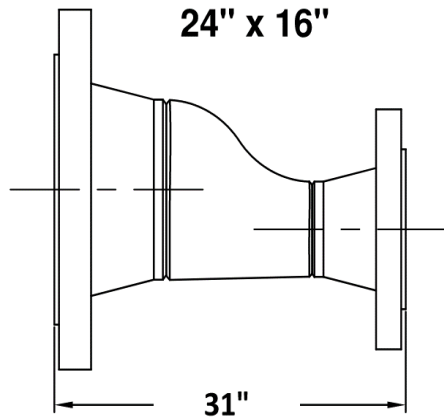

STAINLESS STEEL PIPE SPOOLS SECTION 3 - FITTING DIMENSION DRAWINGS

CROSSES WITH 150# RAISED FACE WELD NECK FLANGES

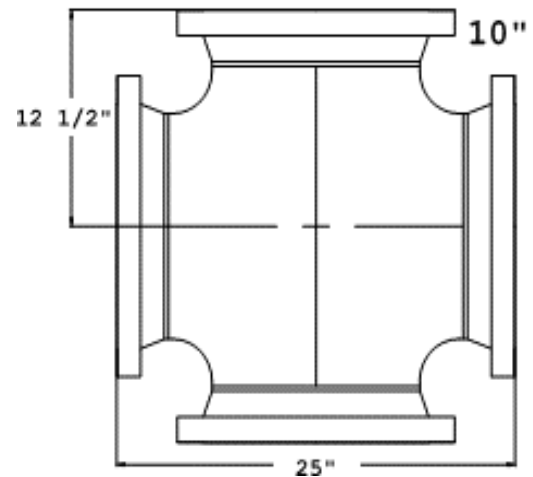
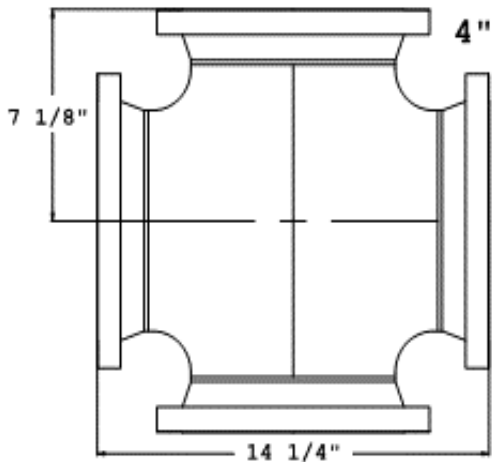
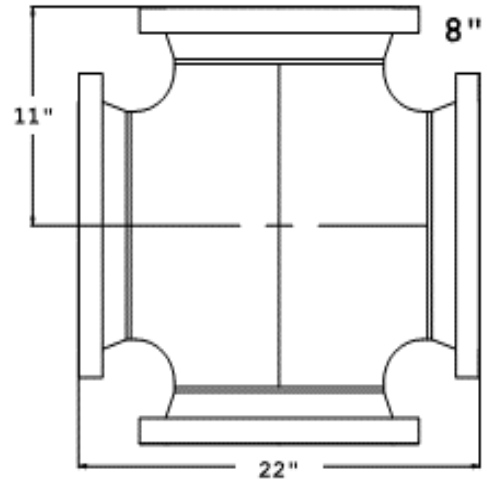
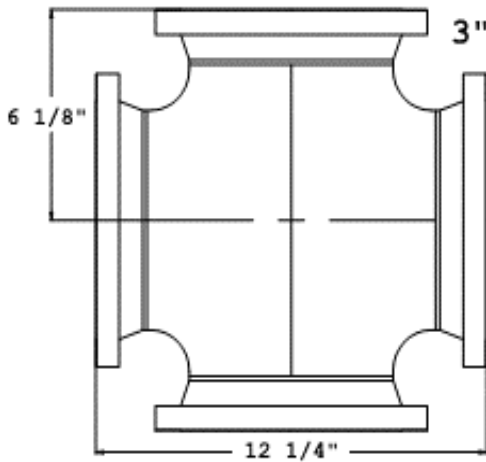
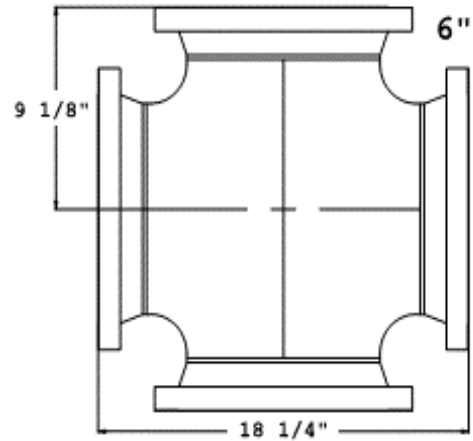
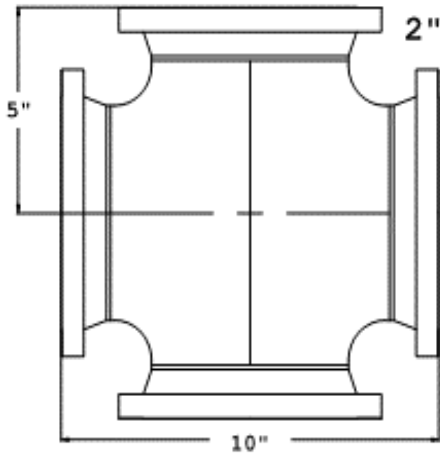

STAINLESS STEEL PIPE SPOOLS SECTION 3 - FITTING DIMENSION DRAWINGS

CROSSES WITH 150# RAISED FACE WELD NECK FLANGES

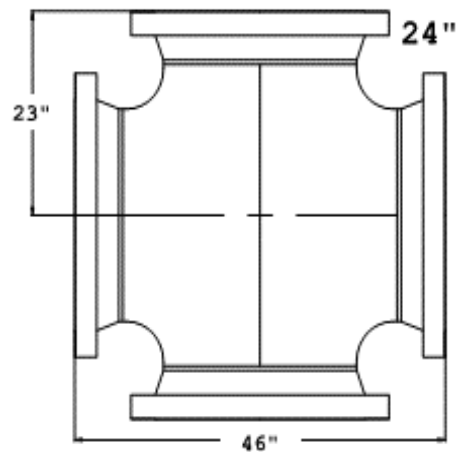
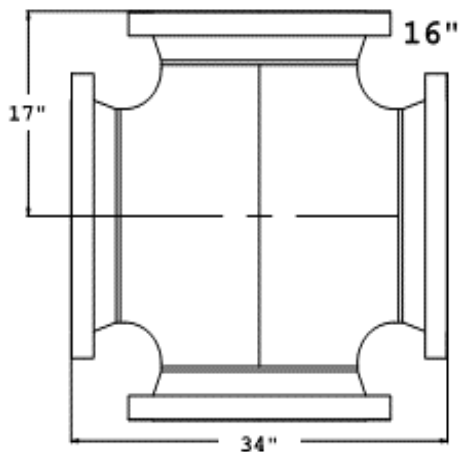
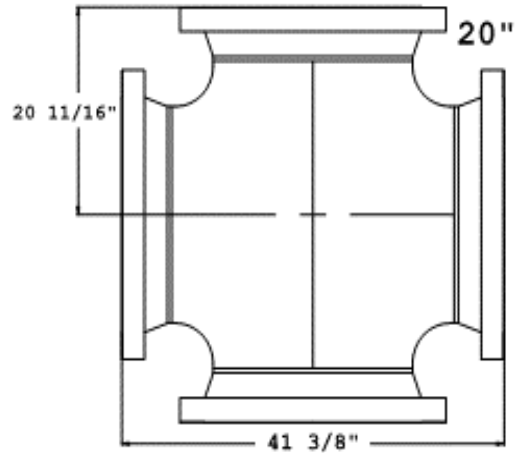
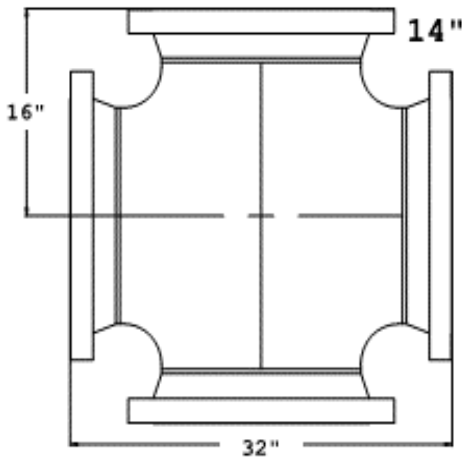
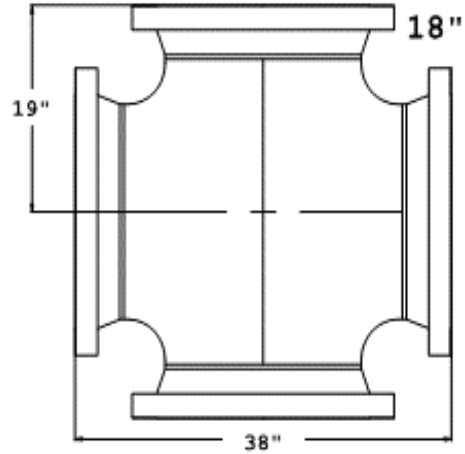
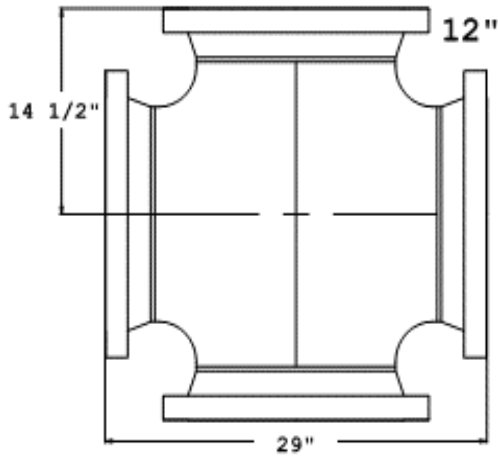

STAINLESS STEEL PIPE SPOOLS
SECTION 3 - FITTING DIMENSION DRAWINGS

REDUCING CROSSES WITH 150# RAISED FACE WELD NECK FLANGES

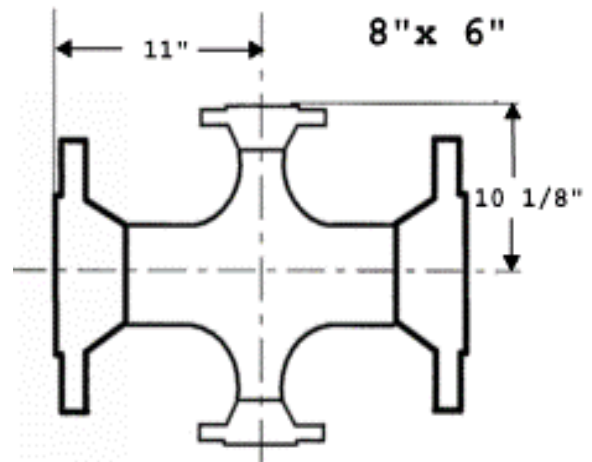
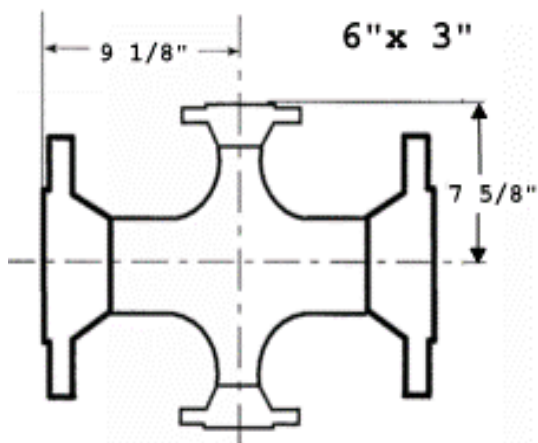
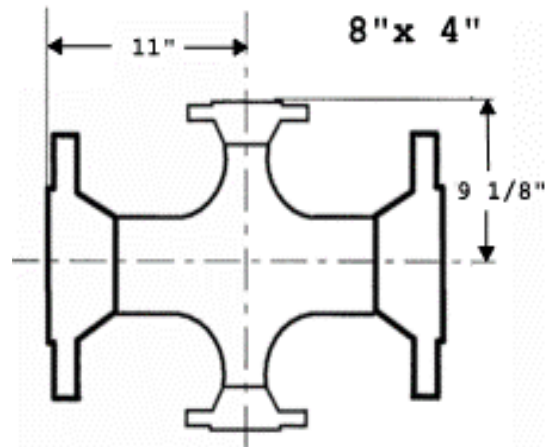
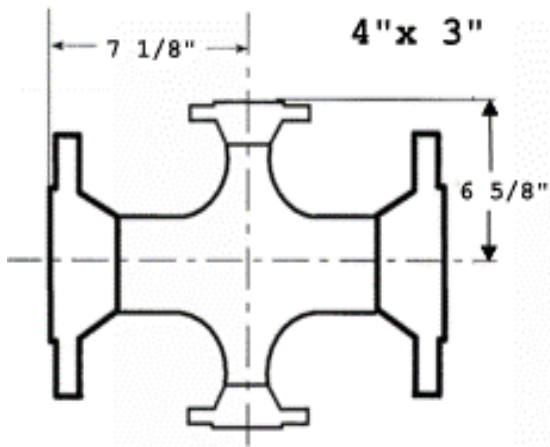
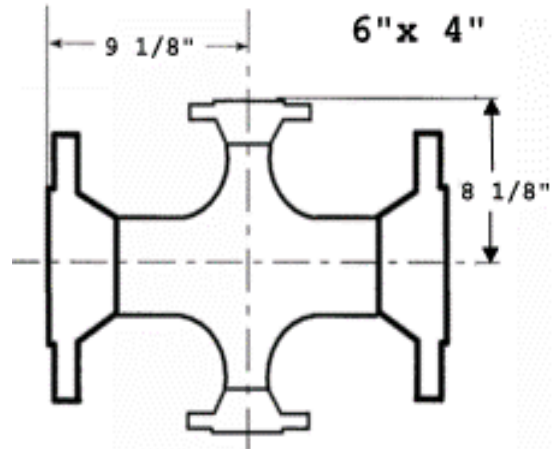
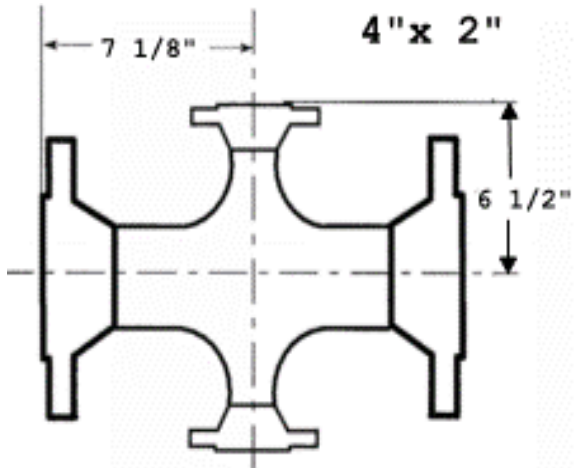

Section 4 - Notes:

1. All material to be Schedule 10S Type 304/304L Stainless Steel. (Other pipe schedules available)
2. Type 316/316L will be quoted as an option as required, replace "304" in the part number with 316.
3. The basic price for straight spools includes only two welds and two flanges, required pipe length will be added on a cost per inch basis, lengths over 20' will require one additional weld per 20'
4. Welding meets ASME B31.3 for Category "D" Fluid.
5. Dimensions are overall length flange face to flange face or center line to flange face as shown on the sketches.
6. Flanges are Class 150 Weld Neck Raised Face Stainless Steel flanges per ASME B16.5.
 - a. Options for Lap Joint (Vanstone) Flanges or Slip-on Flanges are available.
 - i. For Lap Joint Flange add -LJ to the end of the part number. (Lap joint flanges include a Type "A" stub end and Type 304 SS Backing Ring).
 - ii. For Slip-on flanges add -SO to the end of the part number.
7. For fittings an additional weld plus pipe length will be added as required.
8. Other pipe wall thicknesses and fitting types and sizes can be quoted as an option.
9. Pipe to be ERW, seamless pipe can be quoted as an option.
10. Price is FOB Richland, WA.
11. Lead times will be provided at time of order.
12. Costs are subject to change without notice.
13. Unless otherwise notified pricing is good for 30 days after quote.
14. Thread-O-Lets and Weld-O-Lets are an add-on part to any spool with a separate part number.
 - a. All O-lets are per MSS SP-97
 - b. The values inside the parentheses will be filled in with a value.
 - i. (LEG) = Leg - Fittings or spools can have from one leg, in the case of a straight spool to four (4) legs in the case of a cross. Legs are designated as "A", "B", "C" or "D".
 - ii. (DIS) = Inches from the face of the flange on that leg or one end of a straight spool to the centerline of the O-Let.
 - iii. (ROT) = Orientation in Degrees from the top of the fitting as drawn facing the open end of the flange for the leg or end of the spool the O-Let is measured from, zero (0) degrees being the top and moving clockwise around the fitting.
 - c. For reducers the large end will be leg (LEG) "A" and the small end would be leg (LEG) "B".
 - d. For orders put the main spool piece on one line with the standard part number. The O-Let should go on the line below as a sub number.
 - i. Example: A 3" tee with 15" of pipe to be added to leg "C" would be line 1. with its part number followed on the next line with a part number for a branch outlet, a 1" thread-o-let on 5" in at 180 degrees:
 1. 3" Type 304 Stainless Steel Tee - Part Number: 304-TEE-0-0-15
 - 1.1 1" Type 304 Stainless Steel Thread-O-Let - Part Number: 304-1-TOL-C-5-180
15. Passivation per weld for heat affected zones is provided as a service utilizing CitriSurf 2210 or equal per manufactures instruction. There is no warranty written or implied to protect from unknown chemicals or corrosives.
 - a. Passivated spools will be designated with -PAS after the part number.

Published by:
Intermech, Inc.
654 Truman Avenue
Richland, WA 99352
509.628.9141
astaats@intermechinc.com

This catalog is published for use by Intermech clients and employees as a guide for estimating purposes only; due to the volatility of stainless steel on the open market pricing may vary.

Contact Amy Staats for questions or quotes.

Revised: April 20, 2023